

CONVEYOR CHAINS

FV SERIES DIN 8165 SOLID PIN CHAIN

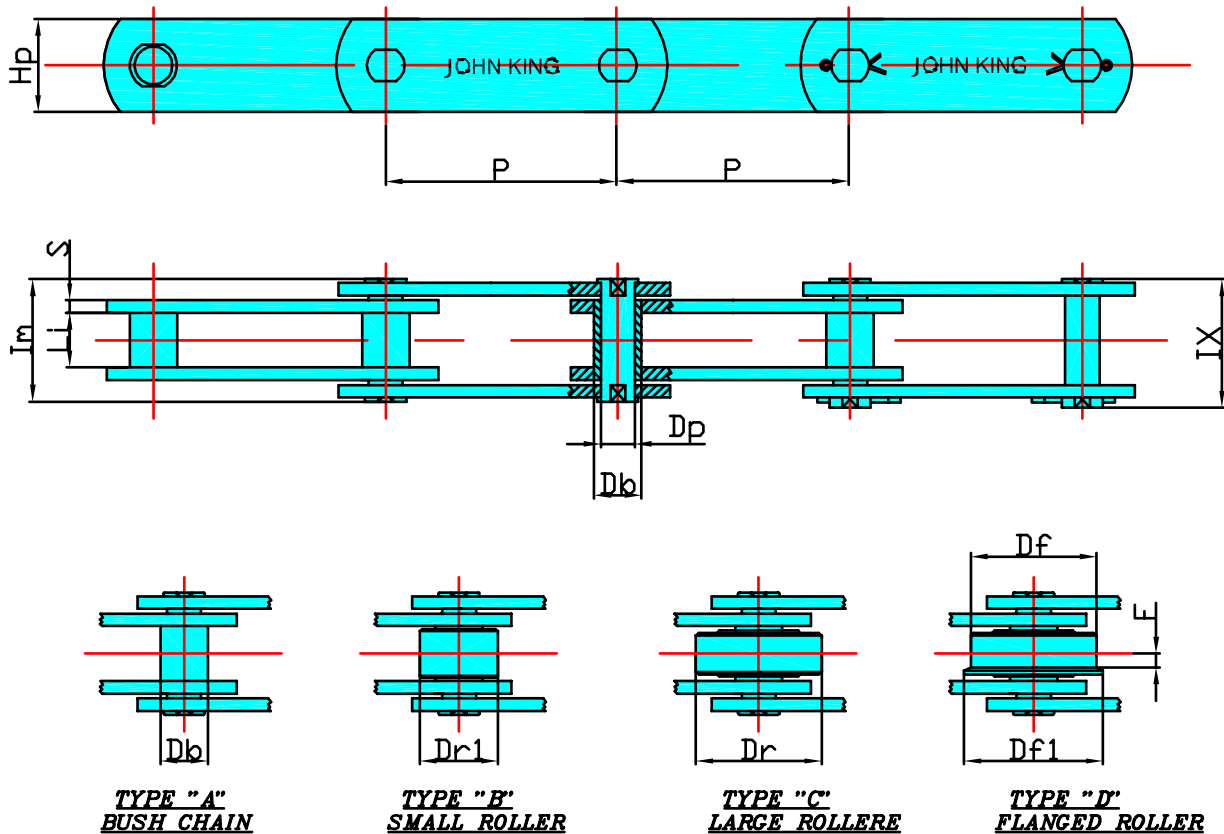

TYPE "A"
BUSH CHAIN

TYPE "B"
SMALL ROLLER

TYPE "C"
LARGE ROLLER

TYPE "D"
FLANGED ROLLER

DIN N°	P mm	Li mm	Dr1 mm	Dr mm	Df mm	Df1 mm	F mm	Db mm	Dp mm	Hp mm	S mm	Im mm	IX mm	BREAKING LOAD	
														N	N *
FV 40	50	18	20	32	40	50	4	15	10	25	3	36	39	42.000	47.000
FV 40	63	18	20	32	40	50	4	15	10	25	3	36	39	42.000	47.000
FV 40	80	18	20	32	40	50	4	15	10	25	3	36	39	42.000	47.000
FV 40	100	18	20	32	40	50	4	15	10	25	3	36	39	42.000	47.000
FV 40	125	18	20	32	40	50	4	15	10	25	3	36	39	42.000	47.000
FV 63	63	22	26	40	50	63	5	18	12	30	4	45	50.5	64.000	75.000
FV 63	80	22	26	40	50	63	5	18	12	30	4	45	50.5	64.000	75.000
FV 63	100	22	26	40	50	63	5	18	12	30	4	45	50.5	64.000	75.000
FV 63	125	22	26	40	50	63	5	18	12	30	4	45	50.5	64.000	75.000
FV 63	160	22	26	40	50	63	5	18	12	30	4	45	50.5	64.000	75.000
FV 90	63	25	30	48	63	78	6.5	20	14	35	5	53	56.5	100.000	115.000
FV 90	80	25	30	48	63	78	6.5	20	14	35	5	53	56.5	100.000	115.000
FV 90	100	25	30	48	63	78	6.5	20	14	35	5	53	56.5	100.000	115.000
FV 90	125	25	30	48	63	78	6.5	20	14	35	5	53	56.5	100.000	115.000
FV 90	160	25	30	48	63	78	6.5	20	14	35	5	53	56.5	100.000	115.000
FV 90	200	25	30	48	63	78	6.5	20	14	35	5	53	56.5	100.000	115.000
FV 90	250	25	30	48	63	78	6.5	20	14	35	5	53	56.5	100.000	115.000



(UK) John King Chains Limited.
New Climax Works, Lancaster Way, Sherburn in Elmet LS25 6NS UK
Telephone: (44) 01977 681910 Facsimile: (44) 01977 681899
E-mail: admin@johnking-chain.com
technical@johnking-chain.com
sales@johnking-chain.com

John King (USA) Inc.
200 Catherine Street, Unit 7B, E. Peoria IL61611 USA
Telephone: 309-698-9250 Facsimile: 309-698-9259
E-mail: salesusa@johnking-chain.com

Web: www.johnkingchains.com

CONVEYOR CHAINS

FV SERIES DIN 8165 SOLID PIN CHAIN

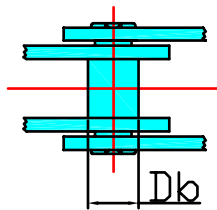
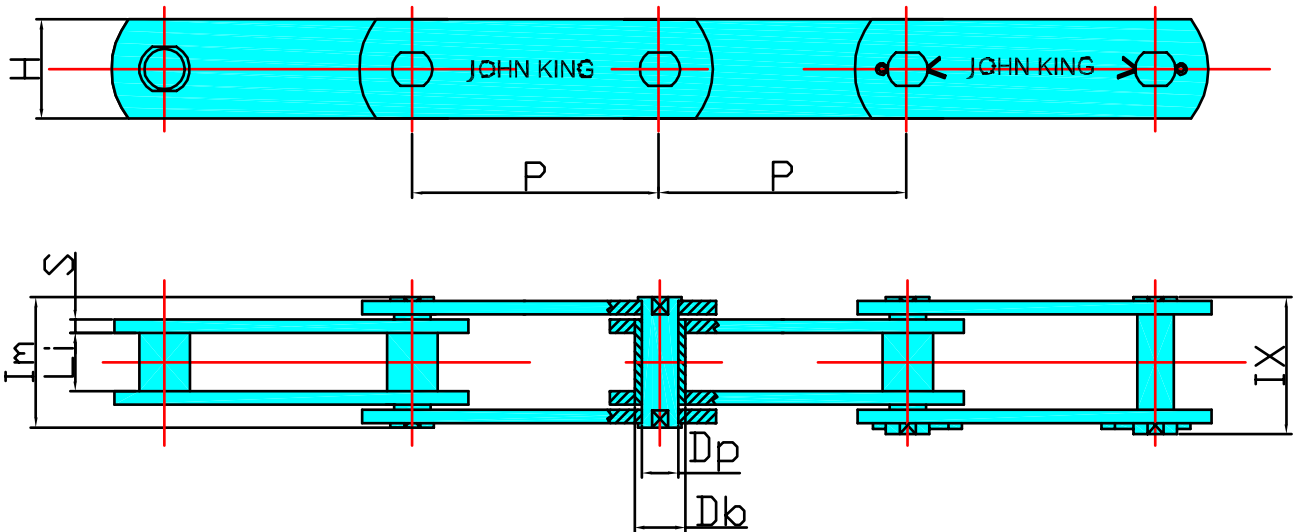

**TYPE "A"
BUSH CHAIN**

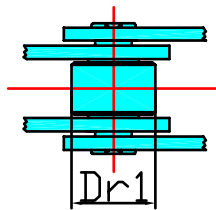

**TYPE "B"
SMALL ROLLER**

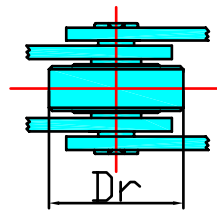

**TYPE "C"
LARGE ROLLER**

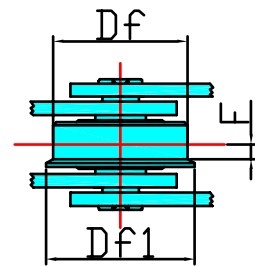

**TYPE "D"
FLANGED ROLLER**

DIN N°	P mm	Li mm	Dr1 mm	Dr mm	Df mm	Df1 mm	F mm	Db mm	Dp mm	Hp mm	S mm	Im mm	IX mm	BREAKING LOAD	
														N	N *
FV 112	100	30	32	55	72	90	7.5	22	16	40	6	62	66	120.000	170.000
FV 112	125	30	32	55	72	90	7.5	22	16	40	6	62	66	120.000	170.000
FV 112	160	30	32	55	72	90	7.5	22	16	40	6	62	66	120.000	170.000
FV 112	200	30	32	55	72	90	7.5	22	16	40	6	62	66	120.000	170.000
FV 112	250	30	32	55	72	90	7.5	22	16	40	6	62	66	120.000	170.000
FV 140	100	35	36	60	80	100	9	26	18	45	6	67	71.5	145.000	180.000
FV 140	125	35	36	60	80	100	9	26	18	45	6	67	71.5	145.000	180.000
FV 140	160	35	36	60	80	100	9	26	18	45	6	67	71.5	145.000	180.000
FV 140	200	35	36	60	80	100	9	26	18	45	6	67	71.5	145.000	180.000
FV 140	250	35	36	60	80	100	9	26	18	45	6	67	71.5	145.000	180.000
FV 180	125	45	42	70	100	125	13	30	20	50	8	86	92	190.000	250.000
FV 180	160	45	42	70	100	125	13	30	20	50	8	86	92	190.000	250.000
FV 180	200	45	42	70	100	125	13	30	20	50	8	86	92	190.000	250.000
FV 180	250	45	42	70	100	125	13	30	20	50	8	86	92	190.000	250.000
FV 180	315	45	42	70	100	125	13	30	20	50	8	86	92	190.000	250.000
FV 250	160	55	50	80	125	155	15	36	26	60	8	97	103.5	275.000	300.000
FV 250	200	55	50	80	125	155	15	36	26	60	8	97	103.5	275.000	300.000
FV 250	250	55	50	80	125	155	15	36	26	60	8	97	103.5	275.000	300.000
FV 250	315	55	50	80	125	155	15	36	26	60	8	97	103.5	275.000	300.000



(UK) John King Chains Limited.
New Climax Works, Lancaster Way, Sherburn in Elmet LS25 6NS UK
Telephone: (44) 01977 681910 Facsimile: (44) 01977 681899
E-mail: admin@johnking-chain.com
technical@johnking-chain.com
sales@johnking-chain.com

John King (USA) Inc.
200 Catherine Street, Unit 7B, E. Peoria IL61611 USA
Telephone: 309-698-9250 Facsimile: 309-698-9259
E-mail: salesusa@johnking-chain.com

Web: www.johnkingchains.com

CONVEYOR CHAINS

FV SERIES DIN 8165

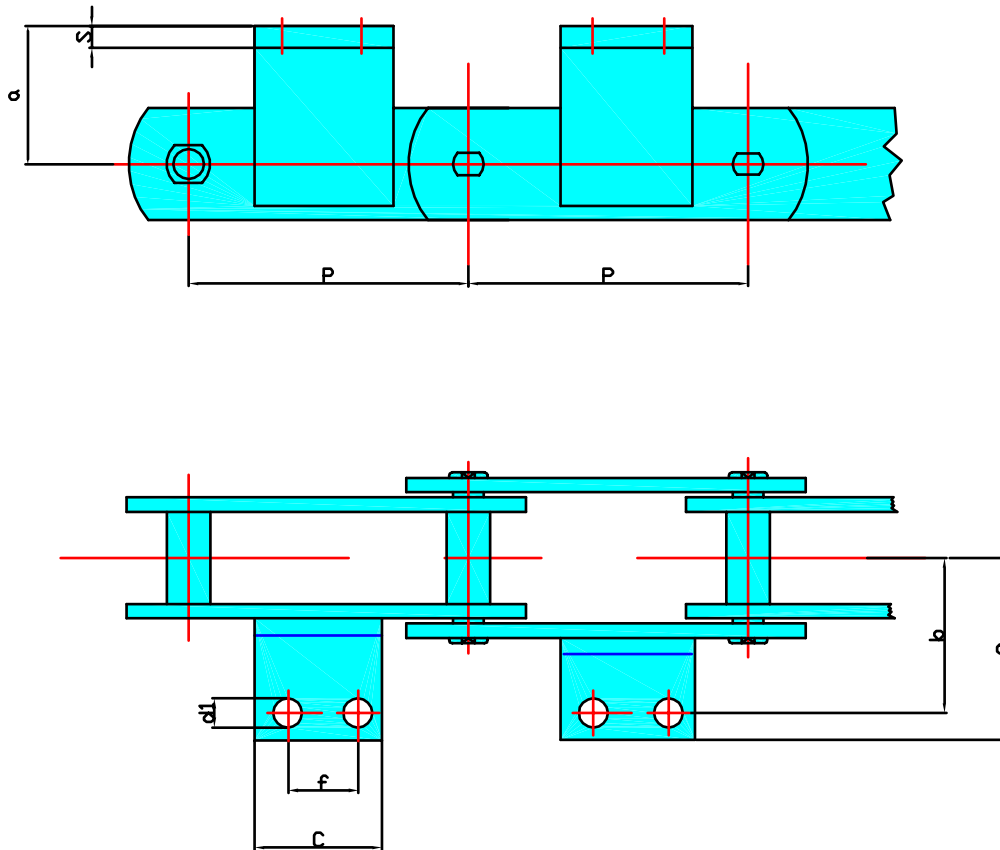

DIN N°	P mm	a mm	b mm	c mm	d1 mm	e mm	f mm	ANGLE IRON mm	CHAIN WEIGHT Kg-m				OVER- WEIGHT Kg./EACH
									TYPE A	TYPE B	TYPE C	TYPE D	
FV 40	50	20	25	45	6.5	64	*	•	2.4	2.9	4	5.6	0.05
FV 40	63	20	25	31	6.5	40.5	*	25x3	2	2.4	3.3	4.5	0.036
FV 40	80	20	25	45	6.5	40.5	25	25x3	1.9	2.2	3	3.9	0.05
FV 40	100	20	25	50	6.5	40.5	30	25x3	1.7	2	2.6	3.3	0.056
FV 40	125	20	25	60	6.5	40.5	30	25x3	1.6	1.9	2.3	3	0.067
FV 63	63	30	34	40	8.4	50	*	30x4	3.8	4.5	6.4	8.9	0.063
FV 63	80	30	34	45	8.4	50	25	30x4	3.2	3.8	5.3	7.2	0.095
FV 63	100	30	34	50	8.4	50	30	30x4	3	3.5	4.7	6.2	0.11
FV 63	125	30	34	60	8.4	50	40	30x4	2.7	3	4	5.3	0.14
FV 63	160	30	34	70	8.4	50	50	30x4	2.4	2.7	3.5	4.4	0.17
FV 90	63	35	40	30	8.4	64	*	40x4	5.6	6.8	10	14.7	0.072
FV 90	80	35	40	45	8.4	64	25	40x4	5.1	6	8.6	12.3	0.11
FV 90	100	35	40	50	8.4	64	30	40x4	4.5	5.3	7.3	10.3	0.13
FV 90	125	35	40	60	8.4	64	40	40x4	4.2	4.8	6.5	8.8	0.16
FV 90	160	35	40	70	8.4	64	50	40x4	4	4.5	5.8	7.6	0.2
FV 90	200	35	40	80	8.4	64	60	40x4	3.5	4.8	4.8	5.8	0.24
FV 90	250	35	40	85	8.4	64	65	40x4	3.4	4.5	4.6	5.4	0.21



(UK) John King Chains Limited.
 New Climax Works, Lancaster Way, Sherburn in Elmet LS25 6NS UK
 Telephone: (44) 01977 681910 Facsimile: (44) 01977 681899
 E-mail: admin@johnking-chain.com
 technical@johnking-chain.com
 sales@johnking-chain.com

John King (USA) Inc.
 200 Catherine Street, Unit 7B, E. Peoria IL61611 USA
 Telephone: 309-698-9250 Facsimile: 309-698-9259
 E-mail: salesusa@johnking-chain.com

Web: www.johnkingchains.com

CONVEYOR CHAINS

FV SERIES DIN 8165 HOLLOW PIN CHAIN

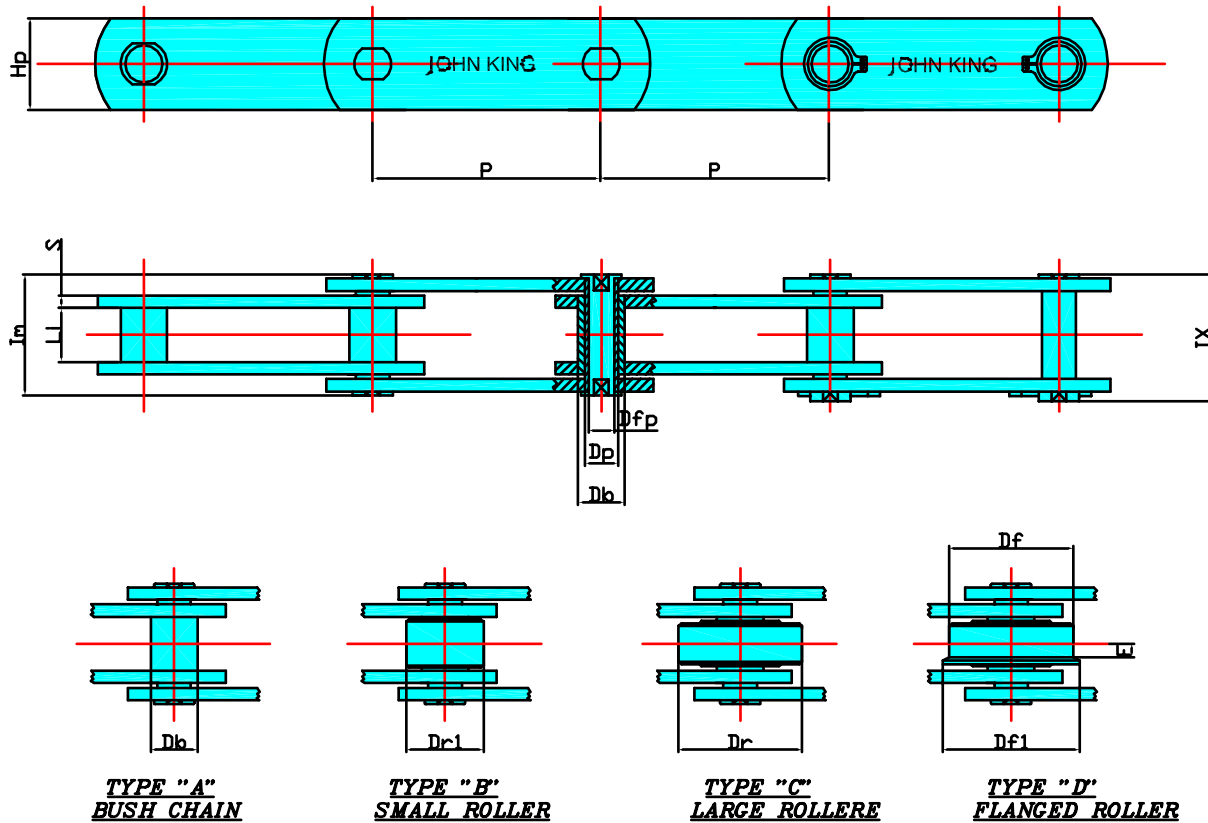

TYPE "A"
BUSH CHAIN

TYPE "B"
SMALL ROLLER

TYPE "C"
LARGE ROLLER

TYPE "D"
FLANGED ROLLER

DIN N°	P mm	Li mm	Dr1 mm	Dr mm	Df mm	Df1 mm	F mm	Db mm	Dp mm	Dfp mm	Hp mm	S mm	Im mm	IX mm	BREAKING LOAD	
															N	N *
FV 63	63	22	26	40	50	63	5	18	12	8	30	4	45	50.5	46.000	75.000
FV 63	80	22	26	40	50	63	5	18	12	8	30	4	45	50.5	46.000	75.000
FV 63	100	22	26	40	50	63	5	18	12	8	30	4	45	50.5	46.000	75.000
FV 63	125	22	26	40	50	63	5	18	12	8	30	4	45	50.5	46.000	75.000
FV 63	160	22	26	40	50	63	5	18	12	8	30	4	45	50.5	46.000	75.000
FV 90	63	25	30	48	63	78	6.5	20	14	10	35	5	53	56.5	73.000	90.000
FV 90	80	25	30	48	63	78	6.5	20	14	10	35	5	53	56.5	73.000	90.000
FV 90	100	25	30	48	63	78	6.5	20	14	10	35	5	53	56.5	73.000	90.000
FV 90	125	25	30	48	63	78	6.5	20	14	10	35	5	53	56.5	73.000	90.000
FV 90	160	25	30	48	63	78	6.5	20	14	10	35	5	53	56.5	73.000	90.000
FV 90	200	25	30	48	63	78	6.5	20	14	10	35	5	53	56.5	73.000	90.000
FV 90	250	25	30	48	63	78	6.5	20	14	10	35	5	53	56.5	73.000	90.000
FV 112	100	30	32	55	72	90	7.5	22	16	11	40	6	62	66	90.000	130.000
FV 112	125	30	32	55	72	90	7.5	22	16	11	40	6	62	66	90.000	130.000
FV 112	160	30	32	55	72	90	7.5	22	16	11	40	6	62	66	90.000	130.000
FV 112	200	30	32	55	72	90	7.5	22	16	11	40	6	62	66	90.000	130.000
FV 112	250	30	32	55	72	90	7.5	22	16	11	40	6	62	66	90.000	130.000



(UK) John King Chains Limited.
New Climax Works, Lancaster Way, Sherburn in Elmet LS25 6NS UK
Telephone: (44) 01977 681910 Facsimile: (44) 01977 681899
E-mail: admin@johnking-chain.com
technical@johnking-chain.com
sales@johnking-chain.com

John King (USA) Inc.
200 Catherine Street, Unit 7B, E. Peoria IL61611 USA
Telephone: 309-698-9250 Facsimile: 309-698-9259
E-mail: salesusa@johnking-chain.com

Web: www.johnkingchains.com

CONVEYOR CHAINS

FV SERIES DIN 8165 HOLLOW PIN CHAIN

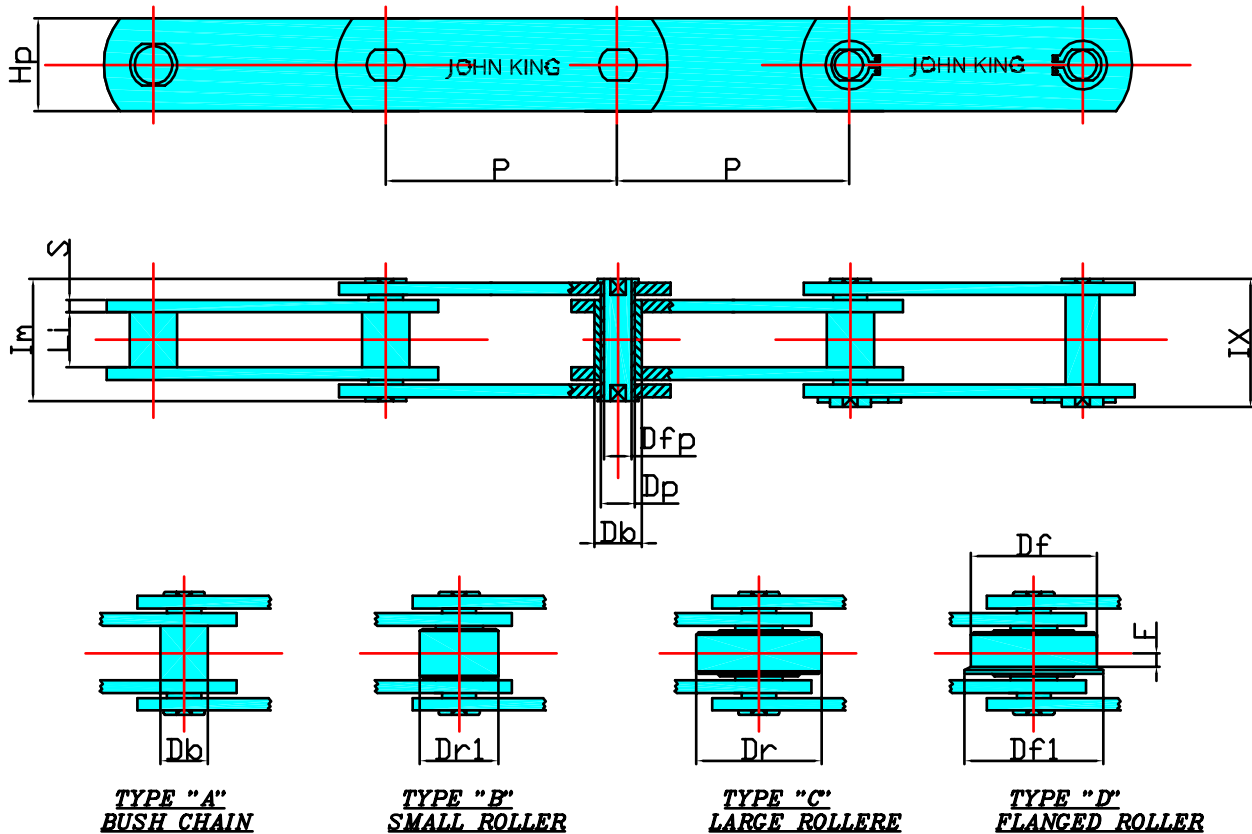

TYPE "A"
BUSH CHAIN

TYPE "B"
SMALL ROLLER

TYPE "C"
LARGE ROLLER

TYPE "D"
FLANGED ROLLER

DIN N°	P mm	Li mm	Dr1 mm	Dr mm	Df mm	Df1 mm	F mm	Db mm	Dp mm	Dfp mm	Hp mm	S mm	Im mm	IX mm	BREAKING LOAD	
															N	N *
FV 140	100	35	36	60	80	100	9	26	18	12	45	6	67	71.5	110.000	170.000
FV 140	125	35	36	60	80	100	9	26	18	12	45	6	67	71.5	110.000	170.000
FV 140	160	35	36	60	80	100	9	26	18	12	45	6	67	71.5	110.000	170.000
FV 140	200	35	36	60	80	100	9	26	18	12	45	6	67	71.5	110.000	170.000
FV 140	250	35	36	60	80	100	9	26	18	12	45	6	67	71.5	110.000	170.000
FV 180	125	45	42	70	100	125	13	30	20	14	50	8	86	92	145.000	190.000
FV 180	160	45	42	70	100	125	13	30	20	14	50	8	86	92	145.000	190.000
FV 180	200	45	42	70	100	125	13	30	20	14	50	8	86	92	145.000	190.000
FV 180	250	45	42	70	100	125	13	30	20	14	50	8	86	92	145.000	190.000
FV 180	315	45	42	70	100	125	13	30	20	14	50	8	86	92	145.000	190.000
FV 250	160	55	50	80	125	155	15	36	26	18	60	8	97	103.5	215.000	300.000
FV 250	200	55	50	80	125	155	15	36	26	18	60	8	97	103.5	215.000	300.000
FV 250	250	55	50	80	125	155	15	36	26	18	60	8	97	103.5	215.000	300.000
FV 250	315	55	50	80	125	155	15	36	26	18	60	8	97	103.5	215.000	300.000



(UK) John King Chains Limited.
New Climax Works, Lancaster Way, Sherburn in Elmet LS25 6NS UK
Telephone: (44) 01977 681910 Facsimile: (44) 01977 681899
E-mail: admin@johnking-chain.com
technical@johnking-chain.com
sales@johnking-chain.com

John King (USA) Inc.
200 Catherine Street, Unit 7B, E. Peoria IL61611 USA
Telephone: 309-698-9250 Facsimile: 309-698-9259
E-mail: salesusa@johnking-chain.com

Web: www.johnkingchains.com

CONVEYOR CHAINS

FVT SERIES DIN 8165 DEEP LINK SERIES

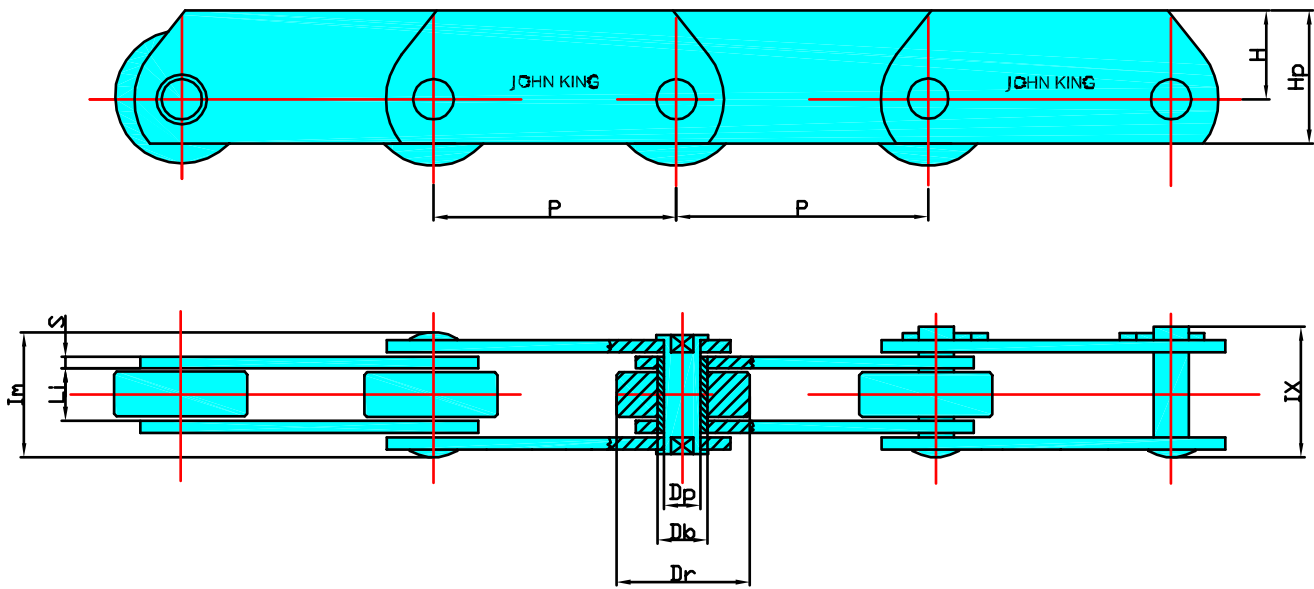

DIN N°	P mm	Li mm	Dr mm	Db mm	Dp mm	Hp mm	H mm	S mm	Im mm	IX mm	BREAKING LOAD		CHAIN WEIGHT Kg-m
											N	N *	
FVT 40	50	18	32	15	10	35	22	3	36	39	42.000	55.000	5
FVT 40	63	18	32	15	10	35	22	3	36	39	42.000	55.000	4.3
FVT 40	80	18	32	15	10	35	22	3	36	39	42.000	55.000	3.8
FVT 40	100	18	32	15	10	35	22	3	36	39	42.000	55.000	3.4
FVT 40	125	18	32	15	10	35	22	3	36	39	42.000	55.000	3
FVT 63	63	22	40	18	12	40	25	4	45	50.5	64.000	90.000	7.5
FVT 63	80	22	40	18	12	40	25	4	45	50.5	64.000	90.000	6.5
FVT 63	100	22	40	18	12	40	25	4	45	50.5	64.000	90.000	5.7
FVT 63	125	22	40	18	12	40	25	4	45	50.5	64.000	90.000	5.1
FVT 63	160	22	40	18	12	40	25	4	45	50.5	64.000	90.000	4.5
FVT 90	63	25	48	20	14	45	27.5	5	53	56.5	100.000	140.000	11.7
FVT 90	80	25	48	20	14	45	27.5	5	53	56.5	100.000	140.000	10
FVT 90	100	25	48	20	14	45	27.5	5	53	56.5	100.000	140.000	8.7
FVT 90	125	25	48	20	14	45	27.5	5	53	56.5	100.000	140.000	7.7
FVT 90	160	25	48	20	14	45	27.5	5	53	56.5	100.000	140.000	6.8
FVT 90	200	25	48	20	14	45	27.5	5	53	56.5	100.000	140.000	5.8
FVT 90	250	25	48	20	14	45	27.5	5	53	56.5	100.000	140.000	5.4
FVT 112	100	30	55	22	16	50	30	6	62	66	120.000	200.000	12.7
FVT 112	125	30	55	22	16	50	30	6	62	66	120.000	200.000	11.7
FVT 112	160	30	55	20	16	50	30	6	62	66	120.000	200.000	9.7
FVT 112	200	30	55	22	16	50	30	6	62	66	120.000	200.000	8.7
FVT 112	250	30	55	22	16	50	30	6	62	66	120.000	200.000	8



(UK) John King Chains Limited.
New Climax Works, Lancaster Way, Sherburn in Elmet LS25 6NS UK
Telephone: (44) 01977 681910 Facsimile: (44) 01977 681899
E-mail: admin@johnking-chain.com
technical@johnking-chain.com
sales@johnking-chain.com

John King (USA) Inc.
200 Catherine Street, Unit 7B, E. Peoria IL61611 USA
Telephone: 309-698-9250 Facsimile: 309-698-9259
E-mail: salesusa@johnking-chain.com

Web: www.johnkingchains.com

CONVEYOR CHAINS

FVT SERIES DIN 8165 DEEP LINK SERIES

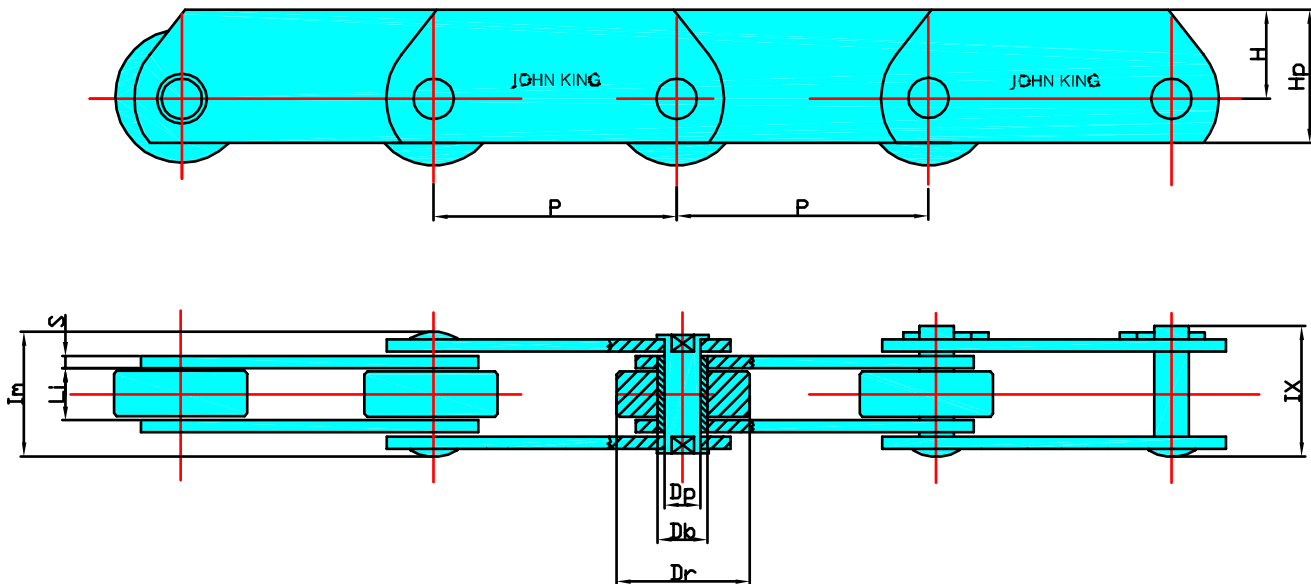

DIN N°	P mm	Li mm	Dr mm	Db mm	Dp mm	Hp mm	H mm	S mm	Im mm	IX mm	BREAKING LOAD		CHAIN WEIGHT Kg-m
											N	N *	
FVT 140	100	35	60	25	18	60	37.5	6	67	71.5	145.000	210.000	16.8
FVT 140	125	35	60	25	18	60	37.5	6	67	71.5	145.000	210.000	14.6
FVT 140	160	35	60	25	18	60	37.5	6	67	71.5	145.000	210.000	12.6
FVT 140	200	35	60	25	18	60	37.5	6	67	71.5	145.000	210.000	11.3
FVT 140	250	35	60	25	18	60	37.5	6	67	71.5	145.000	210.000	10.1
FVT 180	125	45	70	30	20	70	45	8	86	92	190.000	300.000	24.2
FVT 180	160	45	70	30	20	70	45	8	86	92	190.000	300.000	20.8
FVT 180	200	45	70	30	20	70	45	8	86	92	190.000	300.000	18.4
FVT 180	250	45	70	30	20	70	45	8	86	92	190.000	300.000	16.5
FVT 180	315	45	70	30	20	70	45	8	86	92	190.000	300.000	14.9
FVT 250	160	55	80	36	26	80	50	8	97	103.5	275.000	360.000	28.2
FVT 250	200	55	80	36	26	80	50	8	97	103.5	275.000	360.000	24.5
FVT 250	250	55	80	36	26	80	50	8	97	103.5	275.000	360.000	21.7
FVT 250	315	55	80	36	26	80	50	8	97	103.5	275.000	360.000	19.3



(UK) John King Chains Limited.
New Climax Works, Lancaster Way, Sherburn in Elmet LS25 6NS UK
Telephone: (44) 01977 681910 Facsimile: (44) 01977 681899
E-mail: admin@johnking-chain.com
technical@johnking-chain.com
sales@johnking-chain.com

John King (USA) Inc.
200 Catherine Street, Unit 7B, E. Peoria IL61611 USA
Telephone: 309-698-9250 Facsimile: 309-698-9259
E-mail: salesusa@johnking-chain.com

Web: www.johnkingchains.com