

Forged Chains & Sprockets



JOHN KING



Company History and Information



JOHN KING

The John King and Company was established in Leeds, England in 1926 to supply conveyor chains and mechanical handling equipment to the growing world coal industries.

Up to the war years and later the company became the first volume manufacturer of cast link chains to the mechanical handling industry world wide.

From the 1960's to the 1980's John King was the leading manufacturer and exporter of cast link chains in Europe and became a significant exporter to North America. The main markets were timber and water treatment.

Founder: John King

As the chain market evolved and cast link chain usage declined, John King adapted by developing new product lines including welded steel, forged link, engineered steel and engineering plastic chain in addition to traditional product.

Today, John King (Chains) Ltd, offer the widest programme of conveyor chains of any European manufacturer and are exporting their product World Wide.



Climax Works 1930's



Link Production Facility 2004.

John King USA Inc. is a subsidiary of John King (Chains) Ltd., operating from their plant in East Peoria (IL) and being equipped for various types of manufacturing and assembly processes for high quality chain production serving North and South America.

Products are manufactured within the dictates of ISO 9000 to ensure consistent high quality. The John King name is synonymous with a British tradition of courtesy, quality and good value in conveying components.



Chain Assembly 1960's



Fully Automated Forging Plant Ensuring Consistent (High Integrity) Raw Component.



Machining - CNC machining centre offers volume processing with high degrees of accuracy and consistency ensuring ultimate quality.



Heat treatment - In house heat treatment employing the most up to date process plant ensures the uniform surface hardness and depth is maintained. Optimum performance in service is therefore guaranteed.



Welding preparation - Automatic flight assembly demands that the different flight arrangements are mounted in fixtures and prepared for welding.



Robotic welding - Automatic welding produces consistent high strength and crack free welding between link and chain flight.



Quality control - As an ISO - certified company all elements of the manufacturing process are subject to a documented management quality system.

King Drop Forged Chain

Link Material Options

- Manganese Alloy Steel (18MnCr B5) Case Hardened (MN Grade)
- Chrome-Nickel Alloy Steel (18NiCoMo5) Case Hardened (CN Grade)
- Carbon Steel (C45) Hardened & Tempered (C Grade)
- Chrome Molly Alloy Steel (42CrMo4) Hardened & Tempered (CD Grade)
- Stainless Steel
AISI 304 (S3)
AISI 420 (S4)
AISI 316 (S5)

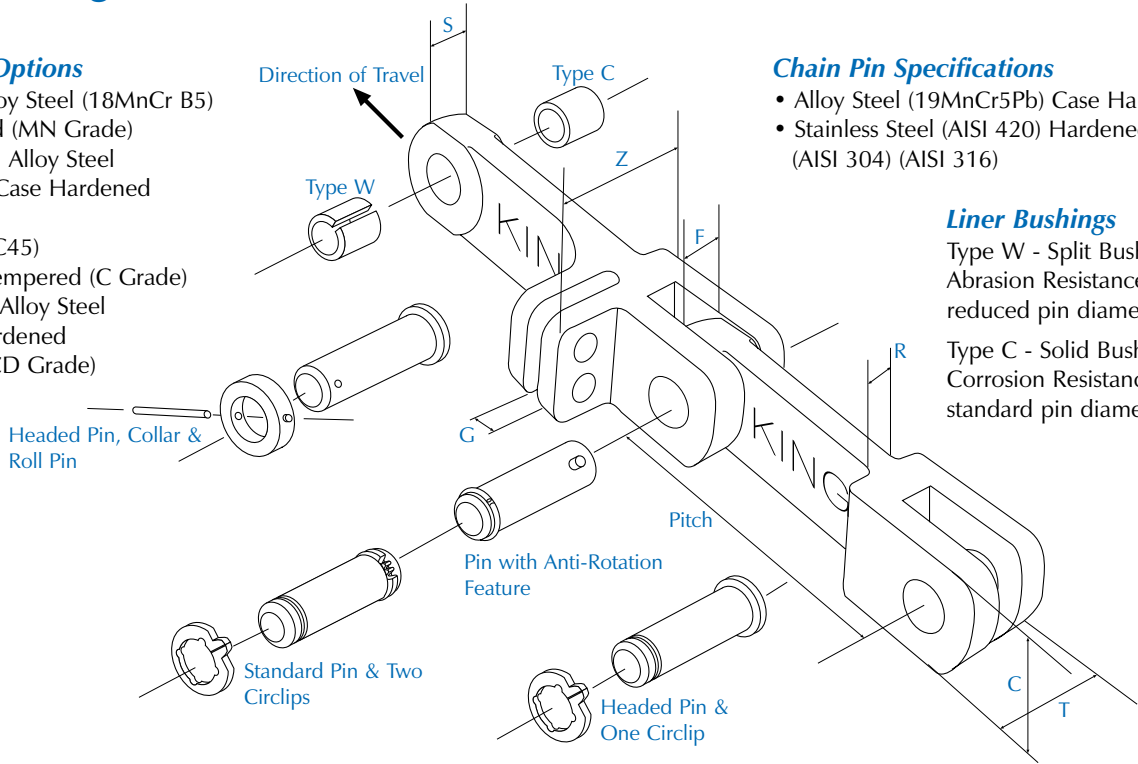

Chain Pin Specifications

- Alloy Steel (19MnCr5Pb) Case Hardened
- Stainless Steel (AISI 420) Hardened & Tempered (AISI 304) (AISI 316)

Liner Bushings

Type W - Split Bushing for Abrasion Resistance with reduced pin diameter

Type C - Solid Bushing for Corrosion Resistance with standard pin diameter

Forged Link Standard Series

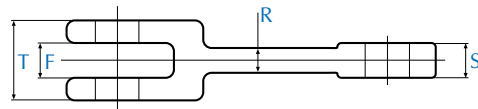
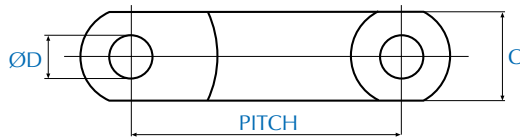

All measurements in mm.

CHAIN No.	PITCH	T	C	S	F	R	ØD	MINIMUM ULTIMATE STRENGTH KN				WEIGHT Kgs/Mtr
								MN	CN	C	CD	
10160	101.6	24	36	8	10	6	14	110	120	150	210	3.5
10160/R	101.6	30	36	13	14	9	14	180	195	235	330	4.8
14214	142	30	40	13	14	9	18	180	195	235	330	4.9
14218	142	42	50	19	20	11	25	290	320	370	550	9.4
14226	142	62	50	28	30	15	25	440	470	570	790	13.6
21640	216	64	72	26	28	20	35	720	820	980	1200	20.7
26040	260	70	75	31	33	20	32	840	900	1100	1480	21.0

Forged Link Double Series

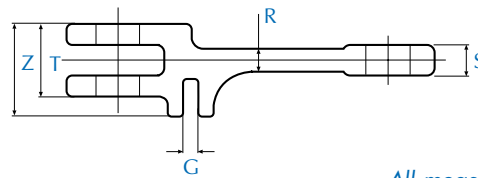
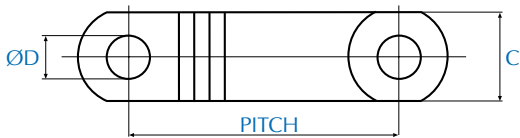

All measurements in mm.

CHAIN No.	PITCH	T	Z	C	S	G	R	ØD	MINIMUM ULTIMATE STRENGTH KN				WEIGHT Kgs/Mtr
									MN	CN	C	CD	
142182	142	42	70	50	19	12	11	25	290	320	370	550	11.6
142262	142	62	87	50	28	12	15	25	440	470	570	790	16.7
175402	175	72	95	60	30	16	23	30	470	530	670	800	20.3
200252	200	60	81	50	25	12	18	25	320	360	460	540	13.0
250602	250	100	140	70	45	21	36	35	850	960	1180	1410	35.2

The tabular dimensions and weights are approximate and are not binding. Design improvements may result in variations from the published figures and verification is recommended.

Typical Flight Arrangements

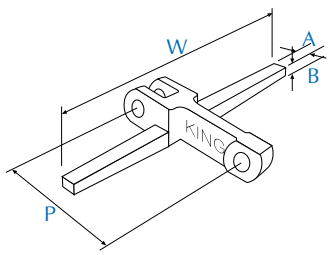

'T' Bar Flight

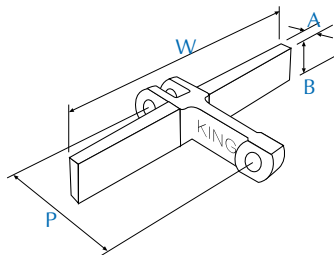

'BT' Plate Flight

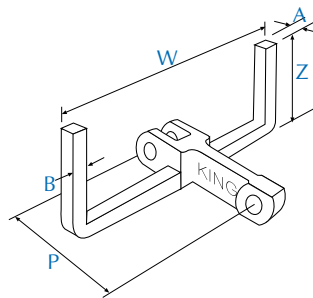

'U' Flight

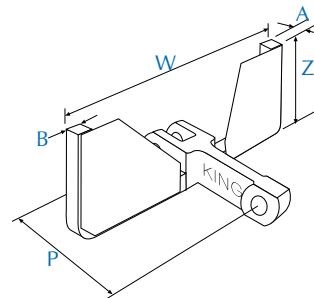

'U' Flight With Blanking Plate

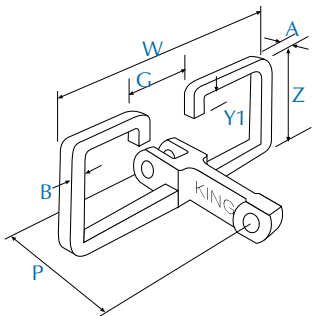

'00' Flight

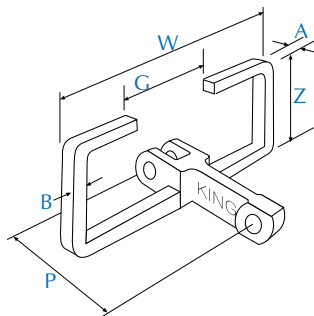

Closed 'C' Flight

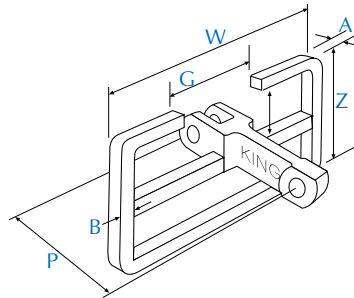

'H' Flight

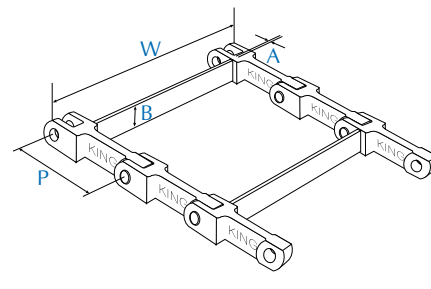

'I' Flight

Plastic Sleeves for Standard Forged Chain

Flight Material

- Extruded UHMW Polyethylene.

All measurements in mm.

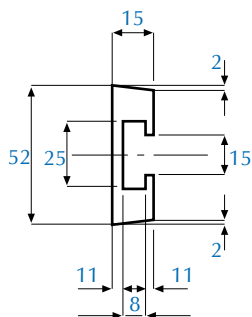
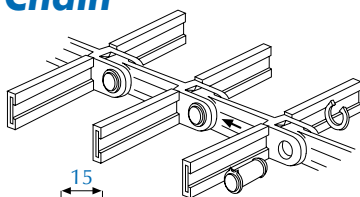

10160
10160R

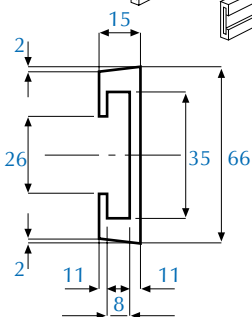

14218
14226

High Manganese Wear Rail

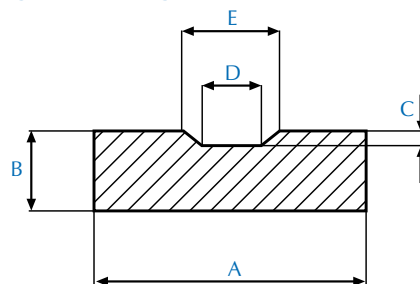

	A mm	B mm	C mm	D mm	E mm	Weight Kgs/Mtr
49/4010	40.0	10.0	2.0	5.0	12.0	3.01
49/5010	50.0	10.0	2.0	5.0	12.0	3.82
49/6010	60.0	10.0	3.0	6.0	16.4	4.45
49/6012	60.0	12.0	2.5	12.0	14.0	5.50
49/6020	60.0	20.0	3.0	6.0	16.4	9.15

Engineering Plastic Flight with Unique Mounting Arrangement (Patent Pending)

Flight Material

- High Impact Resistant Engineering Plastic
(For options refer to our technicians)

FLIGHT No.	MAX WIDTH (ins)	MAX WIDTH (mm)
10160R	15.50	395
14218	29	740
14226	30	760

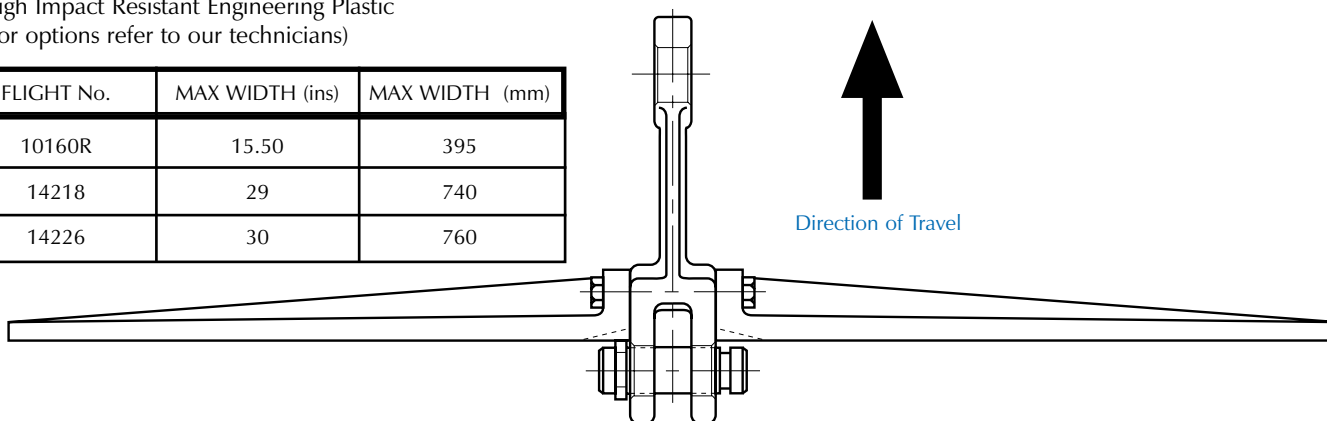

Segmental Sprockets & Hubs - In addition to standards most sizes and designs can be accommodated

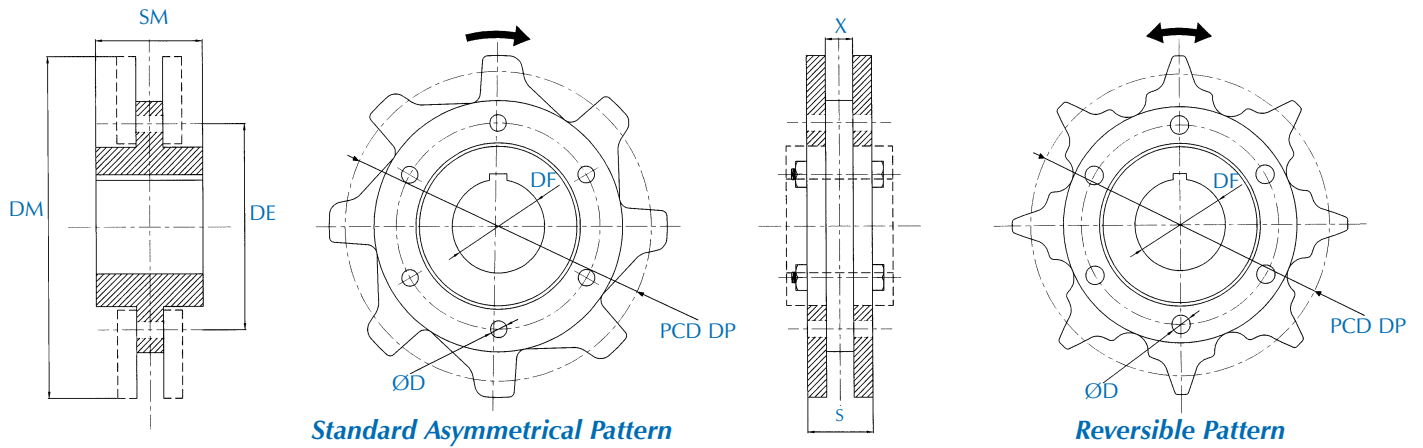

All measurements in mm.

CHAIN No.	No OF TEETH	DM (TOP DIA)	DP PCD	DE (HOLE PCD)	DF (MAX)	ØD	No OF HOLES	S		X		SM
10160 10160R*	6	216	203.2	132	70	10	6	34	36*	10	12*	83
	7	246	235.1	146	70	12	6	34	36*	10	12*	83
	8	277	265.49	168	85	12	6	34	36*	10	12*	83
	10	340	328.78	200	105	12	6	34	36*	10	12*	83
	12	404	392.55	260	105	12	8	34	36*	10	12*	83
14218	6	304	284.0	168	85	12	6	45		15		95
	7	344	327.3	200	105	16	6	45		15		112
	8	390	371.06	241	115	20	8	45		15		127
	9	435	415.18	286	150	20	8	45		15		127
	10	480	459.52	286	150	20	8	45		15		127
	11	524	504.02	368	170	20	8	45		15		150
	12	570	548.64	415	170	20	8	45		15		150
	13	614	593.37	470	170	20	8	45		15		150
14226	7	344	327.3	200	105	16	6	60		20		112
	8	390	371.06	241	114	20	8	60		20		150
	9	435	415.18	286	150	20	8	60		20		150
	10	480	459.52	286	150	20	8	60		20		150
	11	524	504.02	368	170	20	8	60		20		150
	12	570	548.64	415	170	20	8	60		20		150
	13	614	593.37	470	170	20	8	60		20		180
21640	6	459	432.0	247.7	140	20	6	65		25		150
	7	524.8	497.8	311.2	140	24	8	65		25		150
	8	591.4	564.4	381.0	170	20	8	65		25		150
	9	658.5	631.5	431.8	170	24	8	65		25		203
	10	726	699.0	490.0	170	24	8	65		25		203
26040	8	710	679.40	460	180	20	8	82		25		150
	10	870	841.37	460	180	24	8	82		25		150
	12	1035	1004.56	460	180	24	8	82		25		150

The tabular dimensions and weights are approximate and are not binding. Design improvements may result in variations from the published figures and verification is recommended.

Trailer Wheels

Standard Trailer Wheel

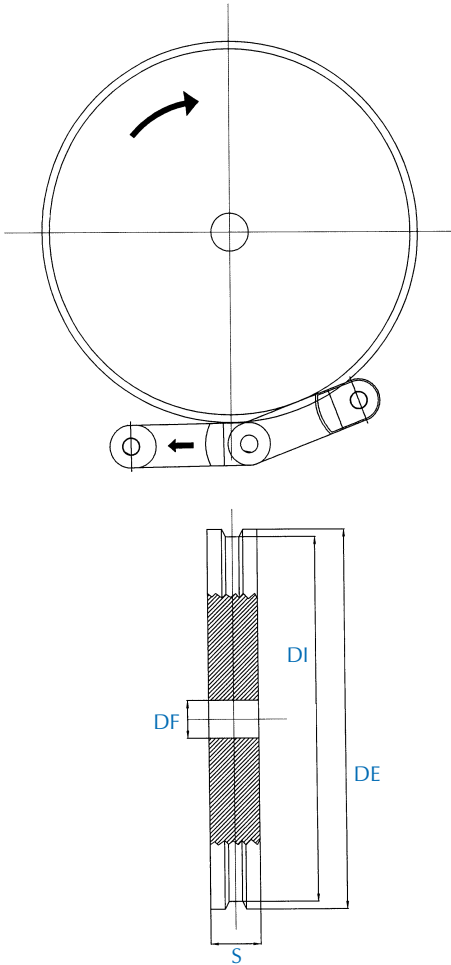

Segmental Trailer Self Cleaning & Reversible

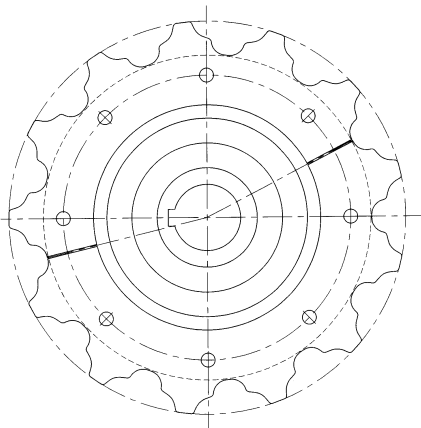

For Boss options refer to our technicians.

Split style hubs available on all trailers.

CHAIN No.	No. OF TEETH	DE (TOP DIA)	DI	DF (MAX)	S	
10160 10160R*	6	160	136	65	35	40*
	7	191	167	65	35	40*
	8	229	205	65	35	40*
	9	260	236	65	35	40*
	10	295	271	65	35	40*
	12	356	332	80	35	40*
	14	420	396	80	35	40*
14218	6	234	210	85	50	
	7	280	256	85	50	
	8	320	296	85	50	
	9	362	338	115	50	
	10	415	391	115	50	
	11	454	430	115	50	
	12	500	476	125	50	
	13	545	521	125	50	
	14	588	564	125	50	
	15	632	608	125	50	
	16	677	653	140	50	
14226	6	234	210	85	70	
	7	280	260	100	70	
	8	320	300	115	70	
	9	362	342	115	70	
	10	415	395	125	70	
	11	454	434	125	70	
	12	500	480	125	70	
	13	545	525	125	70	
	14	588	568	125	70	
	15	632	612	125	70	
	16	677	657	140	70	
21640	6	357	333	120	75	
	7	422	398	120	75	
	8	489	465	150	75	
	10	624	600	180	75	
	13	758	734	200	75	
26040	8	604	580	150	80	
	10	766	742	180	80	
	12	929	905	200	80	

The tabular dimensions and weights are approximate and are not binding. Design improvements may result in variations from the published figures and verification is recommended.

John King Chains Limited, New Climax Works, Lancaster Business Park, Sherburn-in-Elmet LS25 6NS UK
 Tel: (44) 01977 681910 Facsimile: (44) 01977 681899 E-mail: general@johnkingchains.co.uk
 Website: www.johnkingchains.com

John King USA, Inc. 200 Catherine St. Unit 7B, E. Peoria IL 61611 USA
 Ph: 309.642.1789 Fax: 309.353.8552 E-mail: chrisrobinson@johnking-chain.com
 Website: www.johnkingchains.com



REG NO: FM77342



JOHN KING