

## ACETAL CASE CHAINS

## PM600 / PM600D

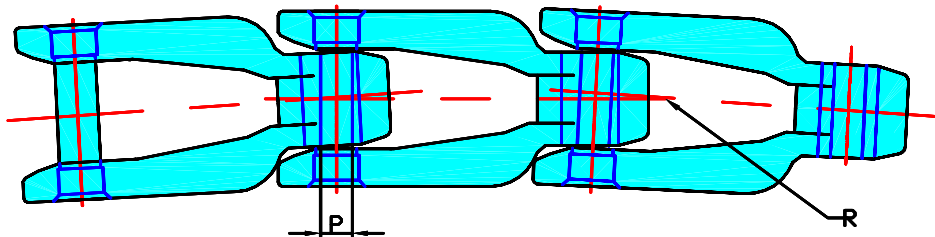
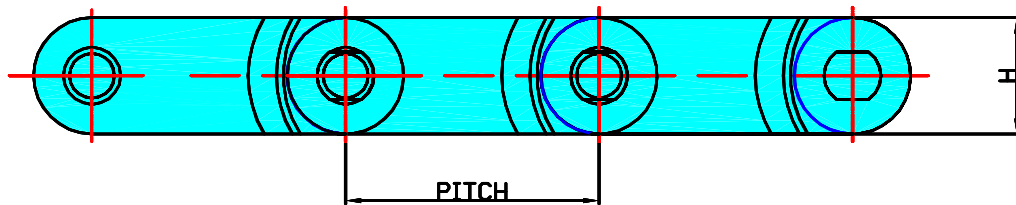

### STANDARD TYPE

### D TYPE

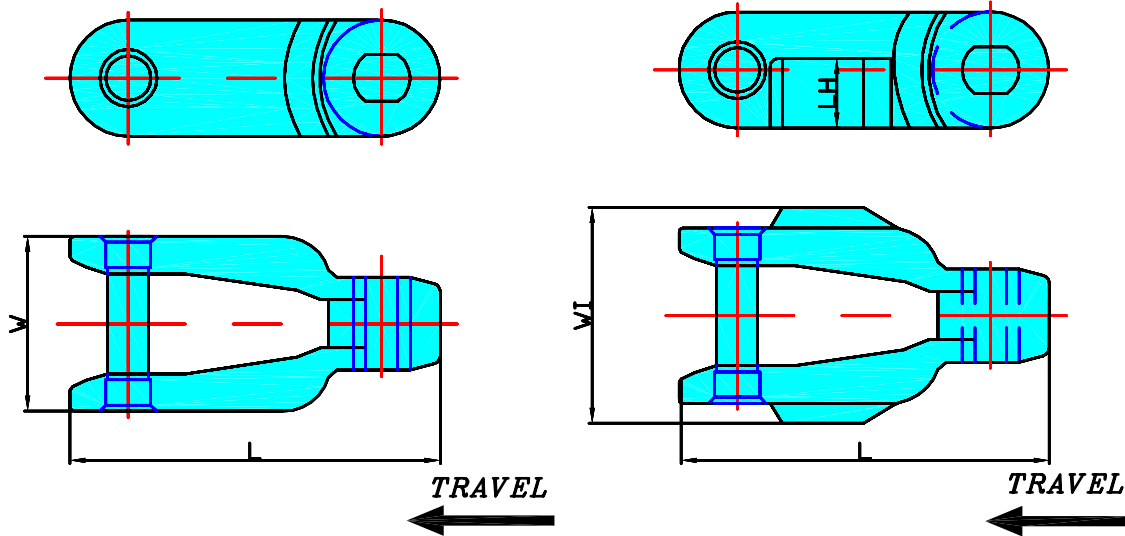

CHAIN N°	PITCH		P		PIN TYPE	L		W		WI		H		LH		R	CHAIN wt/m	UTS	MAX LOAD	
	in	mm	in	mm		in	mm	in	mm	in	mm	in	mm	in	mm					
PM600	2.5	63.5	0.44	11	S,C,R	3.55	90.20	1.69	42.90	-	-	1.12	28.45	-	-	30	762	1.37	1540	840
PM600D	2.5	63.5	0.44	11	S,C,R	3.55	90.20	1.69	42.90	2.12	53.85	1.12	28.45	48	17.02	30	762	1.44	1540	840

Pin types: S- Snap in, C-Circlip, R-Rivet



(UK) John King Chains Limited.  
New Climax Works, Lancaster Way, Sherburn in Elmet LS25 6NS UK  
Telephone: (44) 01977 681910 Facsimile: (44) 01977 681899  
E-mail: admin@johnking-chain.com  
technical@johnking-chain.com  
sales@johnking-chain.com

John King (USA) Inc.  
200 Catherine Street, Unit 7B, E. Peoria IL61611 USA  
Telephone: 309-698-9250 Facsimile: 309-698-9259  
E-mail: salesusa@johnking-chain.com

Web: www.johnkingchains.com

## ACETAL CASE CHAINS

## PM1400 / PM1400D

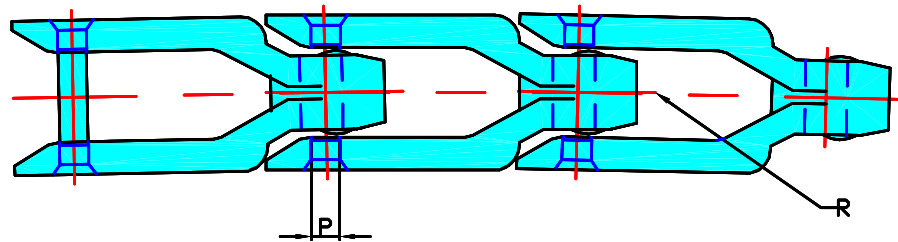
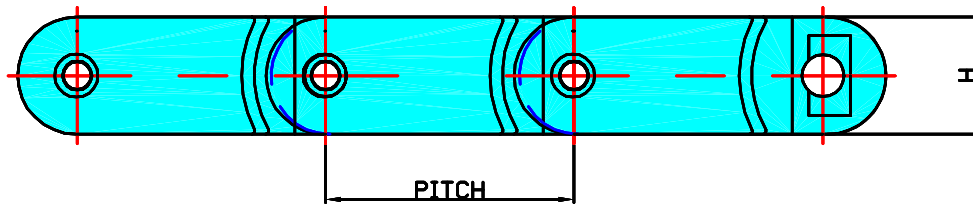

### STANDARD TYPE

### D TYPE

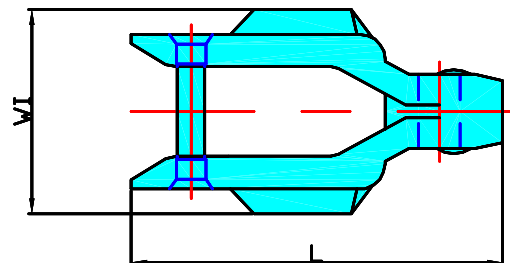
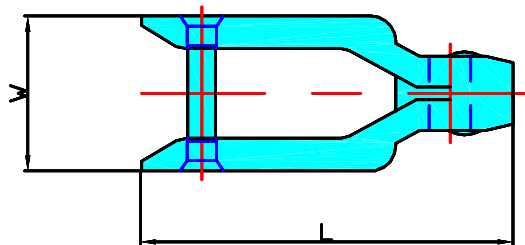
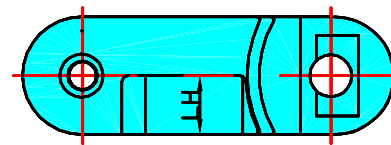
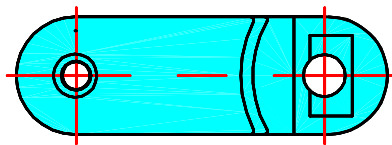

TRAVEL

TRAVEL

CHAIN N°	PITCH		P		PIN TYPE	L		W		WI		H		LH		R	CHAIN wt/m	UTS	MAX LOAD	
	in	mm	in	mm		in	mm	in	mm	in	mm	in	mm	in	mm					in
PM1400	3.25	82.55	0.44	11	S,C,R	4.85	118.10	2.0	50.80	-	-	1.50	38.1	-	-	26	660	2.08	2265	1200
PM1400D	3.25	82.55	0.44	11	S,C,R	4.85	118.10	2.0	50.80	2.625	66.68	1.50	38.1	0.75	19.05	26	660	2.27	2265	1200

Pin types: S- Snap in, C-Circlip, R-Rivet



(UK) John King Chains Limited.  
New Climax Works, Lancaster Way, Sherburn in Elmet LS25 6NS UK  
Telephone: (44) 01977 681910 Facsimile: (44) 01977 681899  
E-mail: admin@johnking-chain.com  
technical@johnking-chain.com  
sales@johnking-chain.com

John King (USA) Inc.  
200 Catherine Street, Unit 7B, E. Peoria IL61611 USA  
Telephone: 309-698-9250 Facsimile: 309-698-9259  
E-mail: salesusa@johnking-chain.com

Web: www.johnkingchains.com

## ACETAL CASE CHAINS

## JK600 / JK600D

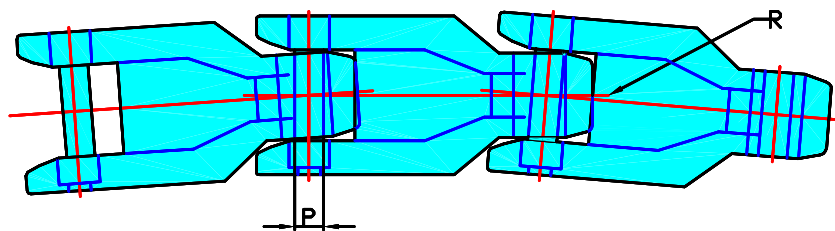
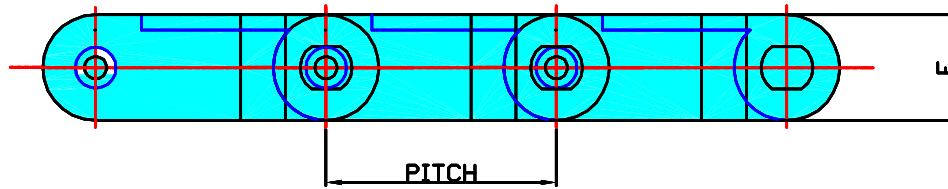

### STANDARD TYPE

### D TYPE

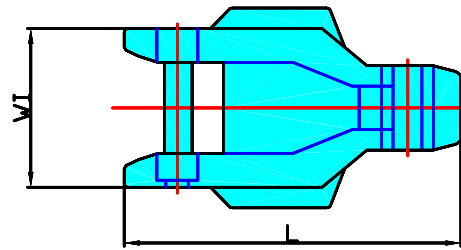
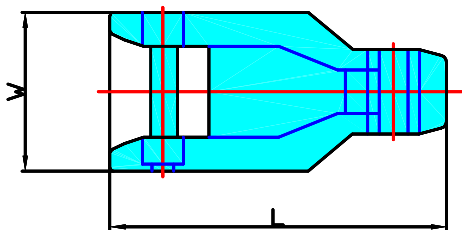
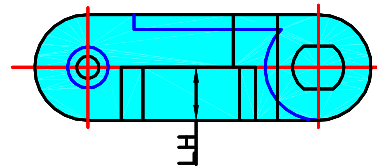
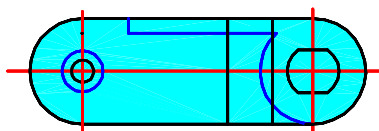

TRAVEL ←

← TRAVEL

CHAIN N°	PITCH		P		PIN TYPE	L		W		WI		H		LH		R	CHAIN wt/m	UTS	MAX LOAD	
	in	mm	in	mm		in	mm	in	mm	in	mm	in	mm	in	mm					in
JK600	2.5	63.5		11	K	3.55	90.20	1.69	42.90	-	-	1.12	28.45	-	-	30	762	1.39	1540	840
JK600D	2.5	63.5	0.44	11	K	3.55	90.20	1.69	42.90	2.12	28.45	1.12	28.45	0.56	14.20	30	762	1.45	1540	840

Pin types: K-Knurled



(UK) John King Chains Limited.  
 New Climax Works, Lancaster Way, Sherburn in Elmet LS25 6NS UK  
 Telephone: (44) 01977 681910 Facsimile: (44) 01977 681899  
 E-mail: admin@johnking-chain.com  
 technical@johnking-chain.com  
 sales@johnking-chain.com

John King (USA) Inc.  
 200 Catherine Street, Unit 7B, E. Peoria IL61611 USA  
 Telephone: 309-698-9250 Facsimile: 309-698-9259  
 E-mail: salesusa@johnking-chain.com

Web: www.johnkingchains.com

## ACETAL CASE CHAINS

## JK1400 / JK1400D

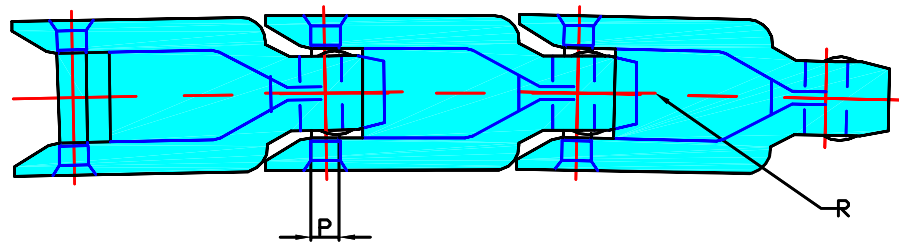
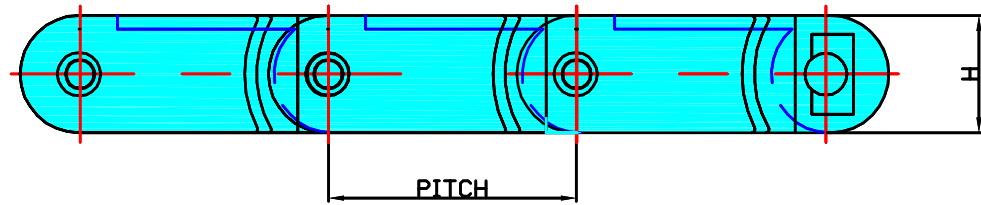

### STANDARD TYPE

### D TYPE

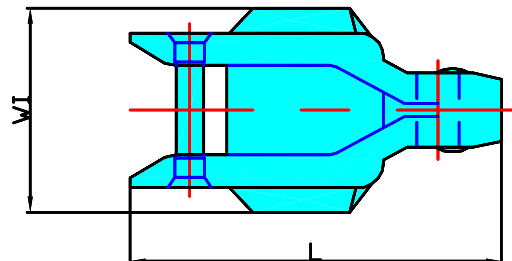
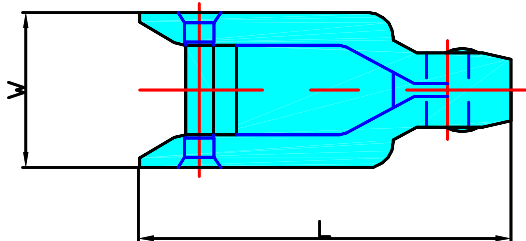
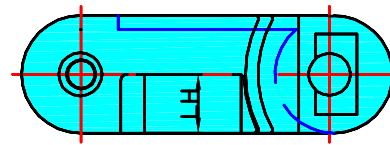
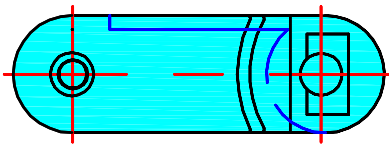

CHAIN N°	PITCH		P		PIN TYPE	L		W		WI		H		LH		R	CHAIN wt/m kg	UTS kg	MAX LOAD kg	
	in	mm	in	mm		in	mm	in	mm	in	mm	in	mm	in	mm					
JK1400	3.25	82.55	0.44	11	S,C,R	4.85	118.10	2.0	50.80	-	-	1.50	38.1	-	-	26	660	2.09	2265	1200
JK1400D	3.25	82.55	0.44	11	S,C,R	4.85	118.10	2.0	50.80	2.625	66.68	1.50	38.1	0.64	16.26	26	660	2.30	2265	1200

Pin types: K-Knurled



(UK) John King Chains Limited.  
 New Climax Works, Lancaster Way, Sherburn in Elmet LS25 6NS UK  
 Telephone: (44) 01977 681910 Facsimile: (44) 01977 681899  
 E-mail: admin@johnking-chain.com  
 technical@johnking-chain.com  
 sales@johnking-chain.com

John King (USA) Inc.  
 200 Catherine Street, Unit 7B, E. Peoria IL61611 USA  
 Telephone: 309-698-9250 Facsimile: 309-698-9259  
 E-mail: salesusa@johnking-chain.com

Web: www.johnkingchains.com

## ACETAL CASE CHAINS

## PM631D

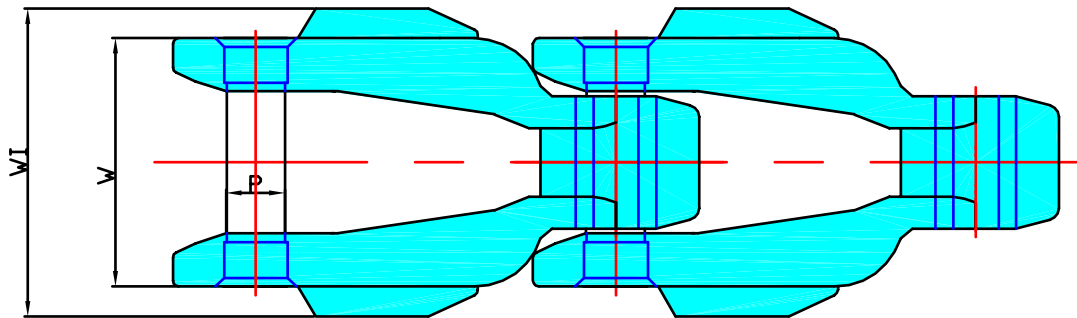
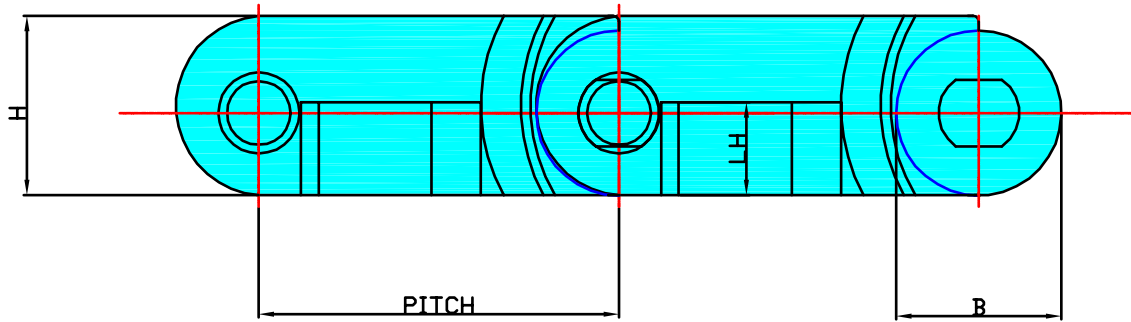

CHAIN N°	PITCH		P		PIN TYPE	B		W		WI		H		LH		MIN TURN RAD.	UTS	MAX LOAD	
	in	mm	in	mm		in	mm	in	mm	in	mm	in	mm	in	mm				in
PM631D	2.5	60.8	0.44	11	S	1.10	27.94	1.67	42.42	2.09	53.1	1.22	31	0.68	16.76	21	762	2.310	1.470

Pin types: S-Snap in



(UK) John King Chains Limited.  
 New Climax Works, Lancaster Way, Sherburn in Elmet LS25 6NS UK  
 Telephone: (44) 01977 681910 Facsimile: (44) 01977 681899  
 E-mail: admin@johnking-chain.com  
 technical@johnking-chain.com  
 sales@johnking-chain.com

John King (USA) Inc.  
 200 Catherine Street, Unit 7B, E. Peoria IL61611 USA  
 Telephone: 309-698-9250 Facsimile: 309-698-9259  
 E-mail: salesusa@johnking-chain.com

Web: www.johnkingchains.com

## ACETAL CASE CHAINS

## PM600F

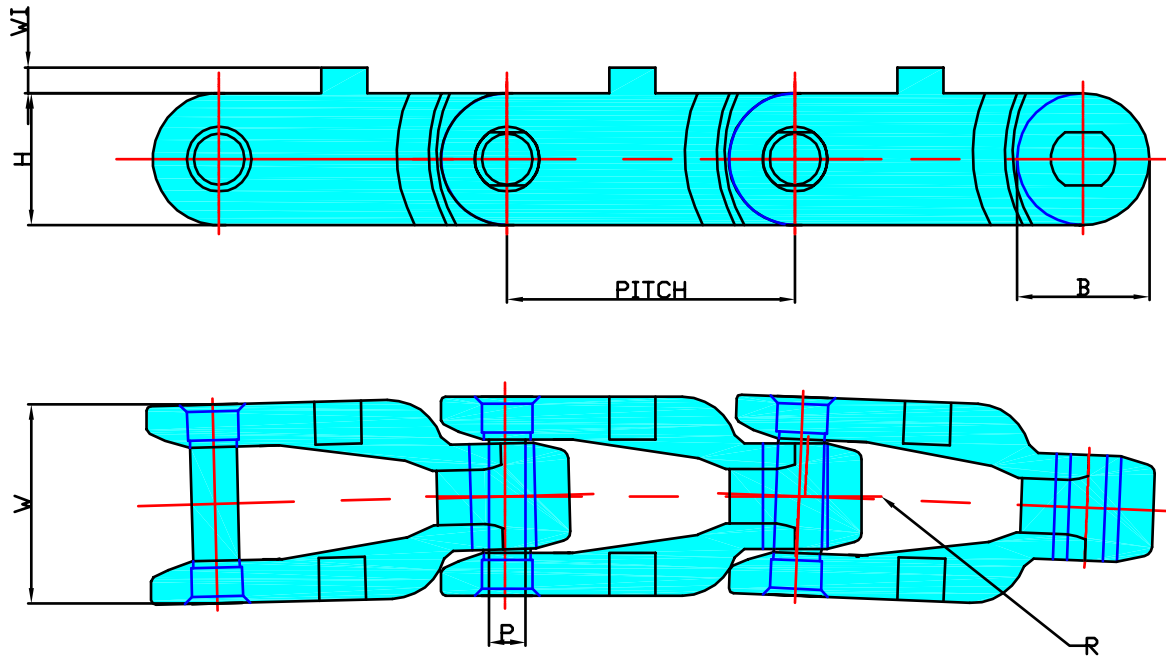

CHAIN N°	PITCH		P		PIN TYPE	B		W		WI		H		MIN TURN RAD.	UTS kg	MAX LOAD kg	
	in	mm	in	mm		in	mm	in	mm	in	mm	in	mm				in
PM631D	2.5	60.8	0.44	11	S,C	1.99	27.94	1.62	42.42	0.22	53.1	1.13	31	30	762	3,400	1,850

Pin types: S-Snap in, C-Circlip



(UK) John King Chains Limited.  
 New Climax Works, Lancaster Way, Sherburn in Elmet LS25 6NS UK  
 Telephone: (44) 01977 681910 Facsimile: (44) 01977 681899  
 E-mail: admin@johnking-chain.com  
 technical@johnking-chain.com  
 sales@johnking-chain.com

John King (USA) Inc.  
 200 Catherine Street, Unit 7B, E. Peoria IL61611 USA  
 Telephone: 309-698-9250 Facsimile: 309-698-9259  
 E-mail: salesusa@johnking-chain.com

Web: www.johnkingchains.com

## ACETAL CASE CHAINS

## PM700 SERIES PINTLE

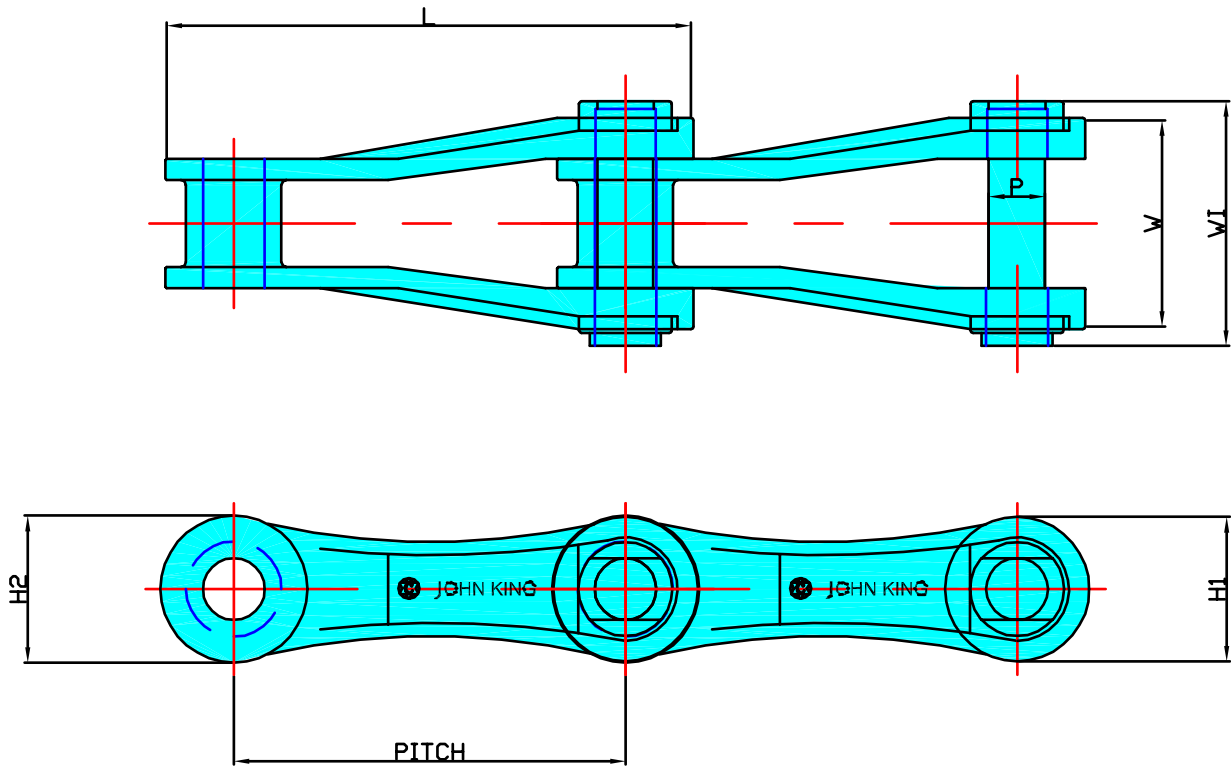

CHAIN N°	PITCH		P		L		W		WI		H1		H2	
	in	mm	in	mm	in	mm	in	mm	in	mm	in	mm	in	mm
PM720	6	152.40	0.94	24	8.22	208.9	3.31	84.0	3.94	100	2.20	56	2.24	57



(UK) John King Chains Limited.  
 New Climax Works, Lancaster Way, Sherburn in Elmet LS25 6NS UK  
 Telephone: (44) 01977 681910 Facsimile: (44) 01977 681899  
 E-mail: admin@johnking-chain.com  
 technical@johnking-chain.com  
 sales@johnking-chain.com

John King (USA) Inc.  
 200 Catherine Street, Unit 7B, E. Peoria IL61611 USA  
 Telephone: 309-698-9250 Facsimile: 309-698-9259  
 E-mail: salesusa@johnking-chain.com

Web: www.johnkingchains.com

## ACETAL CASE CHAINS

## PM700 SERIES PINTLE F22 ATTACHMENT

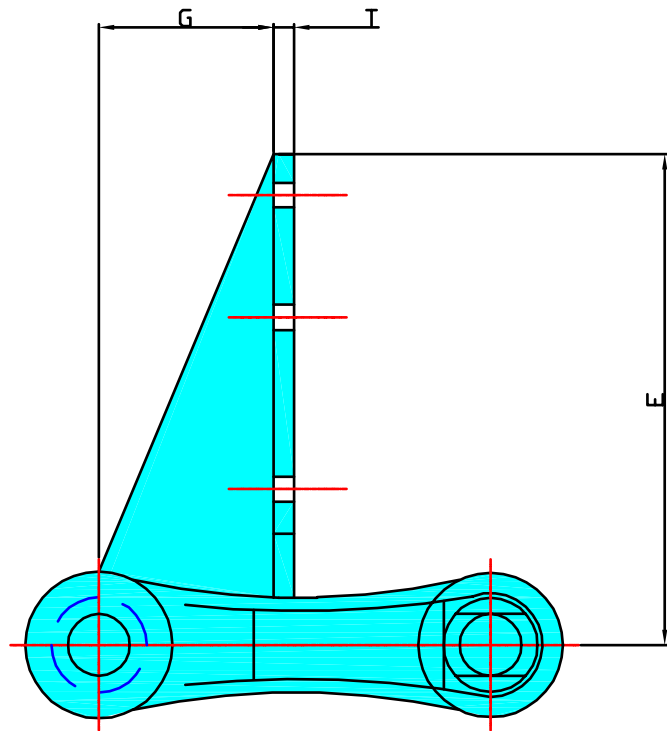
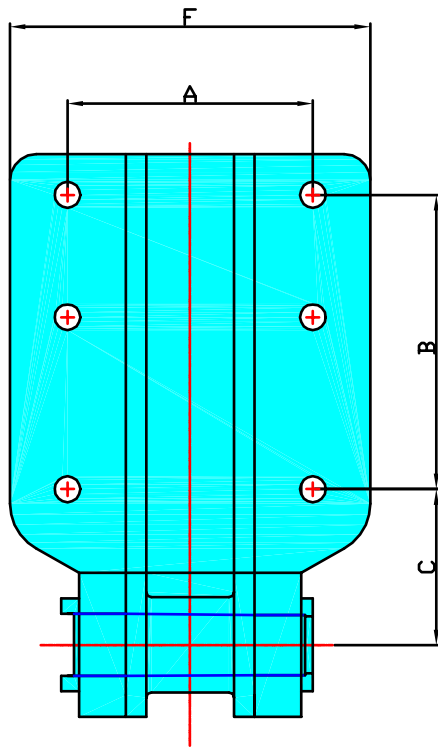

ATTACH N°	A		B		C		E		F		G		T	
	in	mm	in	mm	in	mm	in	mm	in	mm	in	mm	in	mm
F22-6	3.75	95.25	4.5	114.30	3.17	60.45	6.14	155.95	5.5	139.70	3	76.20	0.31	8
F22-8	3.75	95.25	4.5	114.30	3.17	60.45	7.5	190.50	5.5	139.70	3	76.20	0.31	8



(UK) John King Chains Limited.  
 New Climax Works, Lancaster Way, Sherburn in Elmet LS25 6NS UK  
 Telephone: (44) 01977 681910 Facsimile: (44) 01977 681899  
 E-mail: [admin@johnking-chain.com](mailto:admin@johnking-chain.com)  
[technical@johnking-chain.com](mailto:technical@johnking-chain.com)  
[sales@johnking-chain.com](mailto:sales@johnking-chain.com)

John King (USA) Inc.  
 200 Catherine Street, Unit 7B, E. Peoria IL61611 USA  
 Telephone: 309-698-9250 Facsimile: 309-698-9259  
 E-mail: [salesusa@johnking-chain.com](mailto:salesusa@johnking-chain.com)

Web: [www.johnkingchains.com](http://www.johnkingchains.com)

## ACETAL CASE CHAINS

## S PUSHER STYLE ATTACHMENT

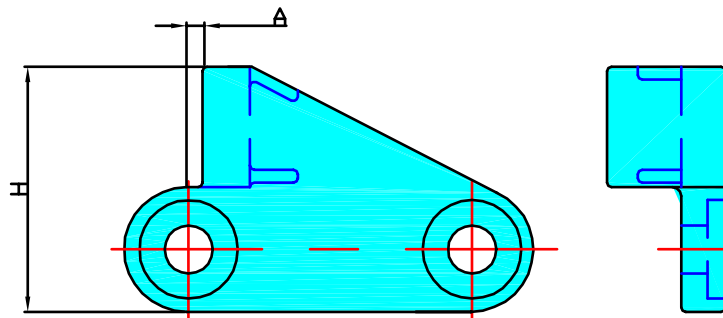
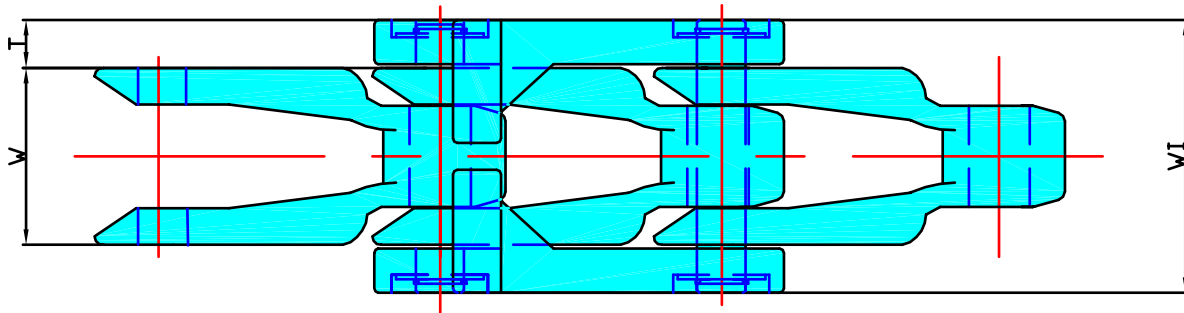
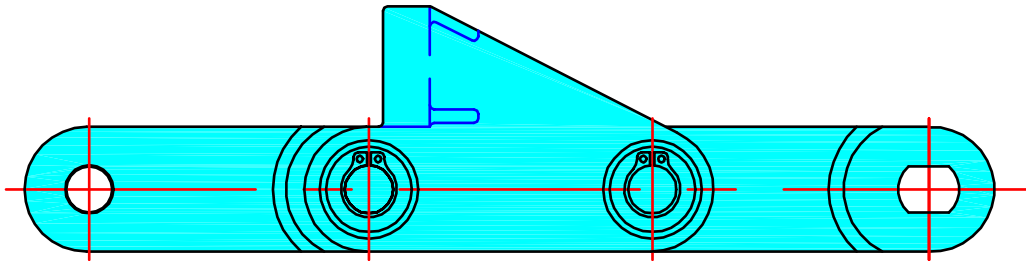

**NOTE:** Attachments are fitted to the outside of the standard PM600 chain using an extended circlip pin, Attachments can be fitted facing inwards or outwards depending on the application

ATTACH N°	A		H		T		W		WI		PIN TYPE
	in	mm	in	mm	in	mm	in	mm	in	mm	
S STYLE	0.19	-	2.20	20.3	0.38	90.20	2.44	58.2	3.87	-	C



## ACETAL CASE CHAINS

## PM1400 WITH TABLE TAP ATTACHMENT

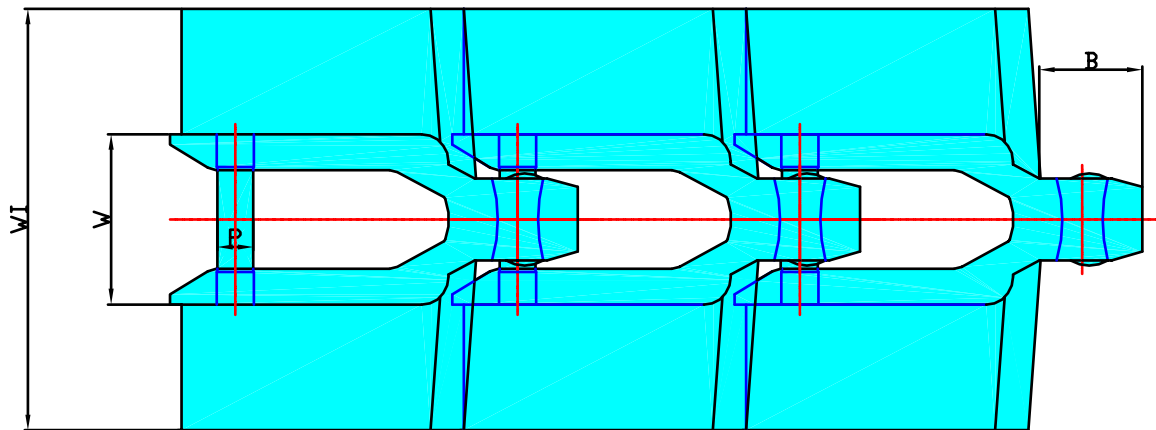
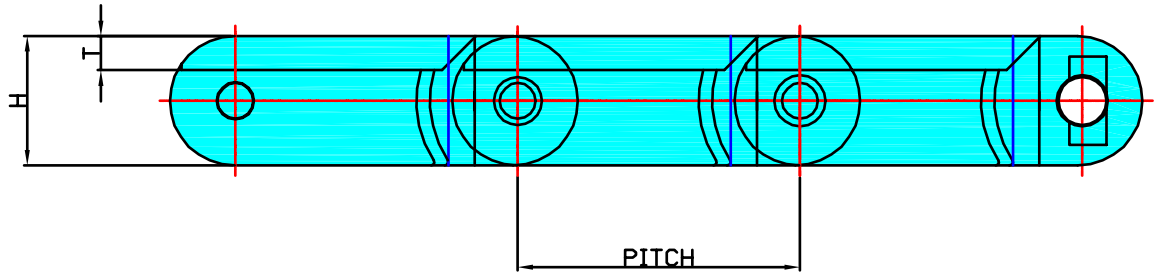

CHAIN N°	PITCH		P		PIN TYPE	B		W		WI		H		T		MIN TURN RAD.	UTS kg	MAX LOAD kg	
	in	mm	in	mm		in	mm	in	mm	in	mm	in	mm	in	mm				
PM1400TT	3.25	82.55	0.44	11	S	1.48	37.6	2	50.8	4.88	124	1.48	37.6	0.40	10.16	48	1219	4.300	2.640

Pin types: S-Snap in



(UK) John King Chains Limited.  
New Climax Works, Lancaster Way, Sherburn in Elmet LS25 6NS UK  
Telephone: (44) 01977 681910 Facsimile: (44) 01977 681899  
E-mail: [admin@johnking-chain.com](mailto:admin@johnking-chain.com)  
[technical@johnking-chain.com](mailto:technical@johnking-chain.com)  
[sales@johnking-chain.com](mailto:sales@johnking-chain.com)

John King (USA) Inc.  
200 Catherine Street, Unit 7B, E. Peoria IL61611 USA  
Telephone: 309-698-9250 Facsimile: 309-698-9259  
E-mail: [salesusa@johnking-chain.com](mailto:salesusa@johnking-chain.com)

Web: [www.johnkingchains.com](http://www.johnkingchains.com)

## ACETAL CASE CHAINS

## PM1700

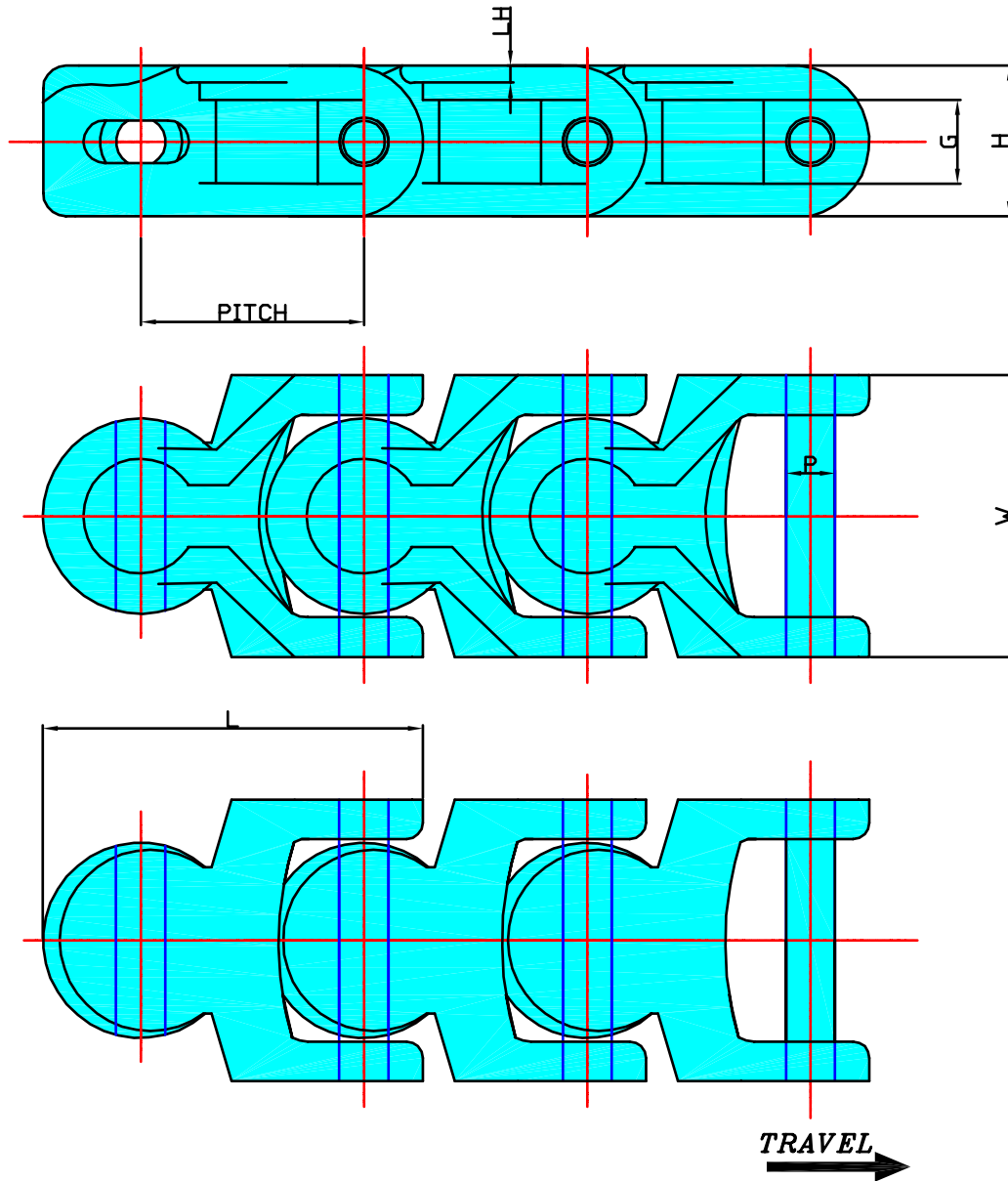

CHAIN N°	PITCH		P		PIN TYPE	L		W		SIDE GROOVE DEPTH G		H		LH		R		CHAIN wt/m kg	UTS kg	MAX LOAD kg
	in	mm	in	mm		in	mm	in	mm	in	mm	in	mm	in	mm	in	mm			
PM1700	1.96	50	0.31	7.94	K	3.16	80.26	1.15	54.60	0.44	11.18	0.94	24	0.126	3.20	5.5	140	1.30	600	360

Pin types: K-Knurled



(UK) John King Chains Limited.  
 New Climax Works, Lancaster Way, Sherburn in Elmet LS25 6NS UK  
 Telephone: (44) 01977 681910 Facsimile: (44) 01977 681899  
 E-mail: [admin@johnking-chain.com](mailto:admin@johnking-chain.com)  
[technical@johnking-chain.com](mailto:technical@johnking-chain.com)  
[sales@johnking-chain.com](mailto:sales@johnking-chain.com)

John King (USA) Inc.  
 200 Catherine Street, Unit 7B, E. Peoria IL61611 USA  
 Telephone: 309-698-9250 Facsimile: 309-698-9259  
 E-mail: [salesusa@johnking-chain.com](mailto:salesusa@johnking-chain.com)

Web: [www.johnkingchains.com](http://www.johnkingchains.com)

## ACETAL CASE CHAINS

## PM508 / 508D

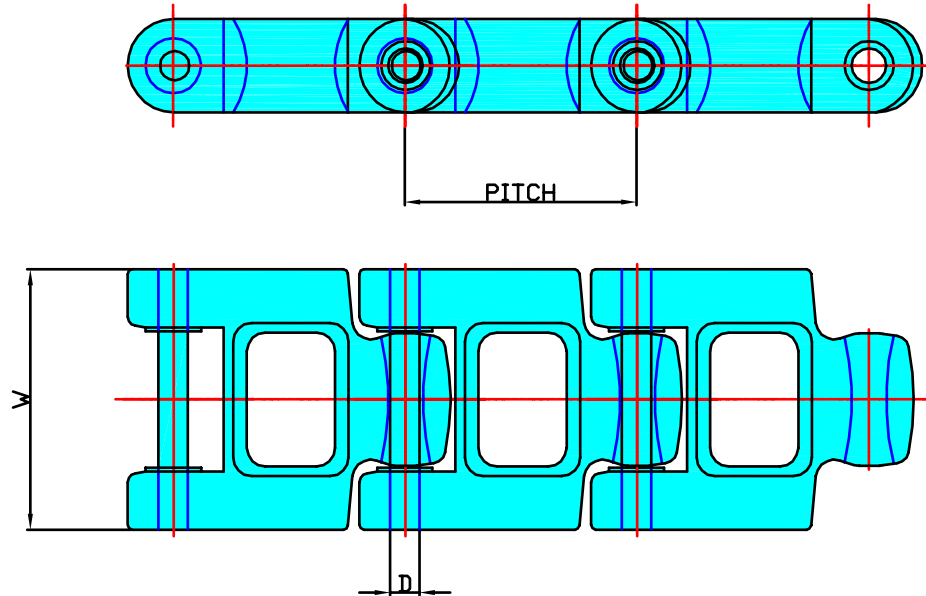

### STANDARD TYPE

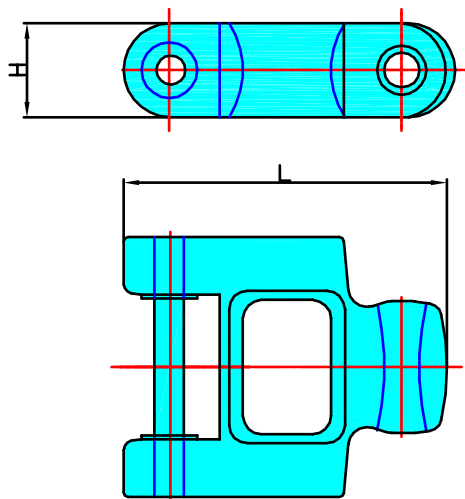

### D TYPE

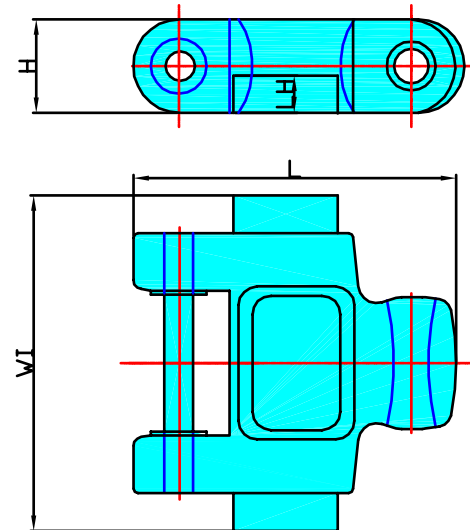

CHAIN N°	PITCH		D		L		W		WI		H		LH		BACKFLEX RADIUS		MIN RADIUS		CHAIN wt/m kg	PERMISSABLE TENSILE FORCE kg
	in	mm	in	mm	in	mm	in	mm	in	mm	in	mm	in	mm	in	mm	in	mm		
PM508	2	50.8	0.25	6.35	2.78	70	2.25	57.2	-	-	0.80	20.3	-	-	2.36	60	-	-	1.28	710
PM508D	2	50.8	0.25	6.35	2.78	70	2.25	57.2	2.75	69.9	0.80	20.3	0.25	6.35	2.36	60	16	406	1.31	570



(UK) John King Chains Limited.  
 New Climax Works, Lancaster Way, Sherburn in Elmet LS25 6NS UK  
 Telephone: (44) 01977 681910 Facsimile: (44) 01977 681899  
 E-mail: [admin@johnking-chain.com](mailto:admin@johnking-chain.com)  
[technical@johnking-chain.com](mailto:technical@johnking-chain.com)  
[sales@johnking-chain.com](mailto:sales@johnking-chain.com)

John King (USA) Inc.  
 200 Catherine Street, Unit 7B, E. Peoria IL61611 USA  
 Telephone: 309-698-9250 Facsimile: 309-698-9259  
 E-mail: [salesusa@johnking-chain.com](mailto:salesusa@johnking-chain.com)

Web: [www.johnkingchains.com](http://www.johnkingchains.com)

## ACETAL CASE CHAINS

## PM600 / PM1400 DRIVE SPROCKETS

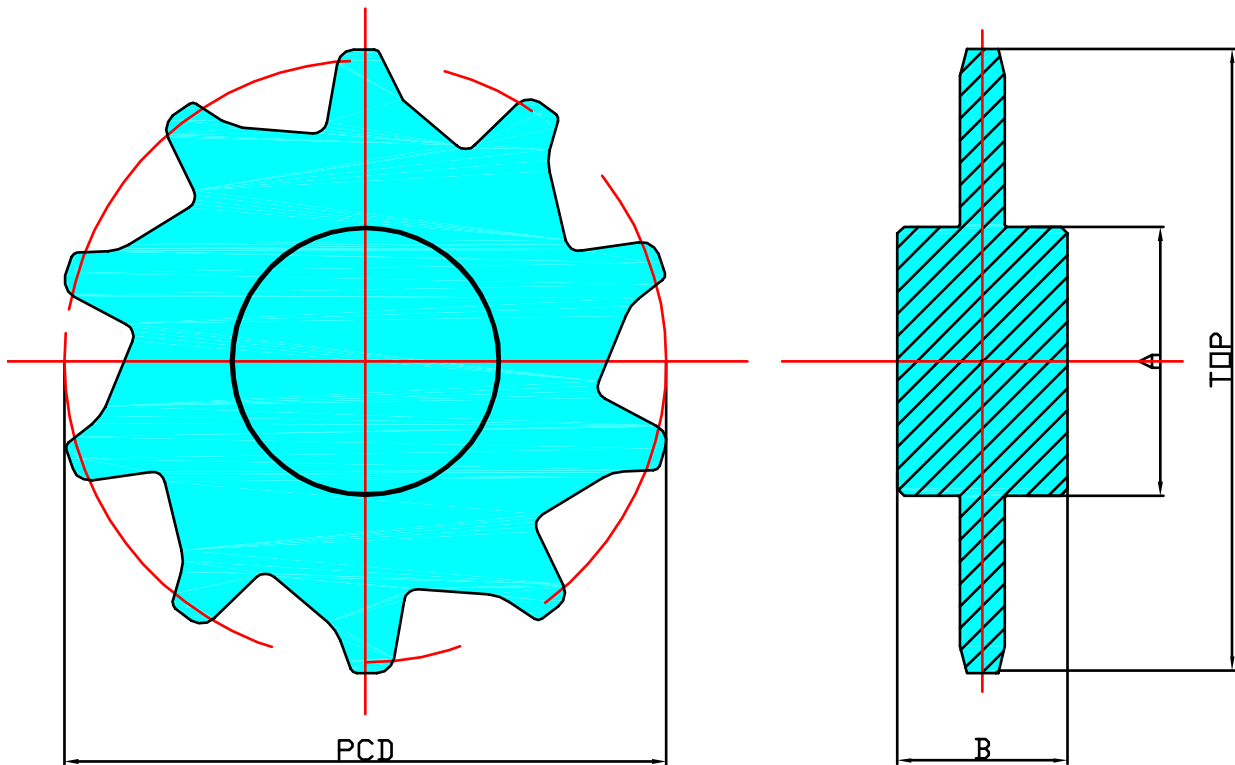

SPROCKET No.	No. OF TEETH	BOSS SIZES				PCD		TOP	
		A		B		in	mm	in	mm
		in	mm	in	mm				
36 / PM600 / 6T	6	3	76.2	2¼	57.15	5.00	127.0	5.60	142.30
36 / PM600 / 8T	8	3½	88.9	2½	63.5	6.53	165.90	7.0	177.80
36 / PM600 / 10T	10	4½	114.3	2½	63.5	8.09	205.50	9.20	234.00
36 / PM600 / 12T	12	5	127	3¾	69.85	9.66	245.40	10.25	260.00
36 / PM600 / 14T	14	5	127	3	76.2	11.24	285.50	12.30	312.00
36 / PM1400 / 8T	8	3½	88.9	2¼	57.15	8.49	215.65	9.40	239.00
36 / PM1400 / 10T	10	4	101.6	3	76.02	10.52	267.20	11.63	295.00
36 / PM1400 / 12T	12	5½	139.7	3	76.02	12.56	319.00	13.75	349.00
36 / PM1400 / 14T	14	5½	139.7	3½	88.9	14.61	371.10	15.80	401.00



## ACETAL CASE CHAINS

## SPLIT CONSTRUCTION DRIVE SPROCKETS

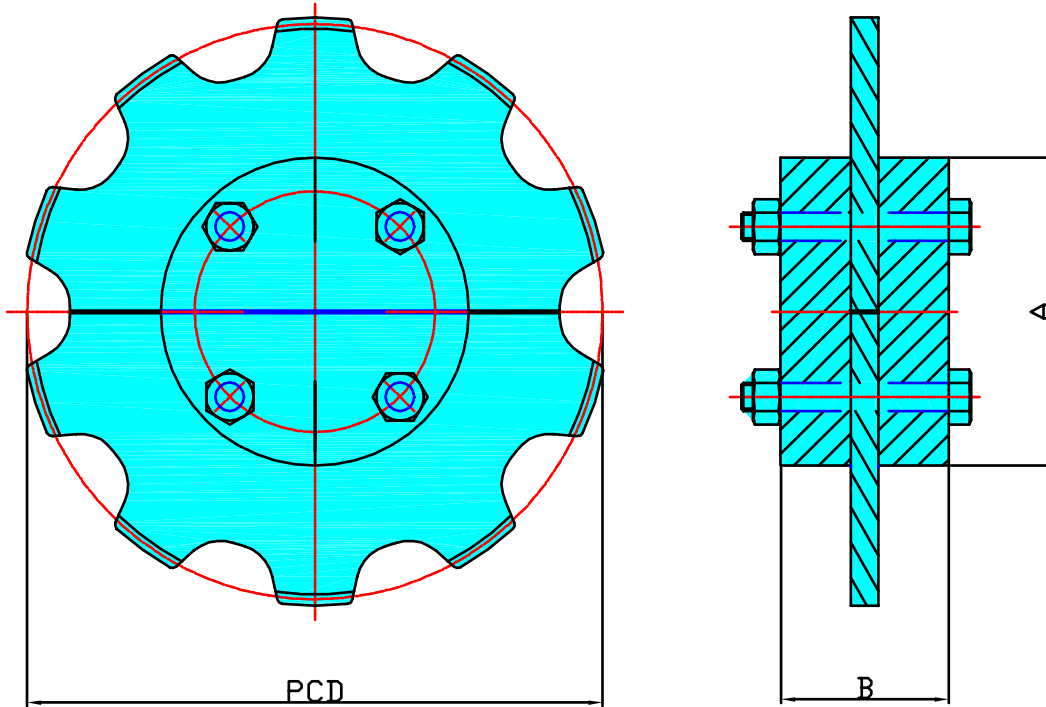

SPROCKET No.	No. OF TEETH	BOSS SIZES				PCD	
		A		B		in	mm
		in	mm	in	mm		
36/PM600/6TS	6	4	100	2	50	5.00	127.0
36/PM600/8TS	8	4	100	2	50	6.53	165.90
36/PM600/10TS	10	4	100	2	50	8.09	205.50
36/PM600/12TS	12	4	100	2	50	9.66	245.40
36/PM600/14TS	14	4	100	2	50	11.24	285.50
36/PM1400/8TS	8	4	100	2½	63.5	8.49	215.65
36/PM1400/10TS	10	4	100	2½	63.5	10.52	267.20
36/PM1400/12TS	12	4	100	2½	63.5	12.56	319.00
36/PM1400/14TS	14	4	100	2½	63.5	14.61	371.10



## ACETAL CASE CHAINS

## PM1700 DRIVE SPROCKETS

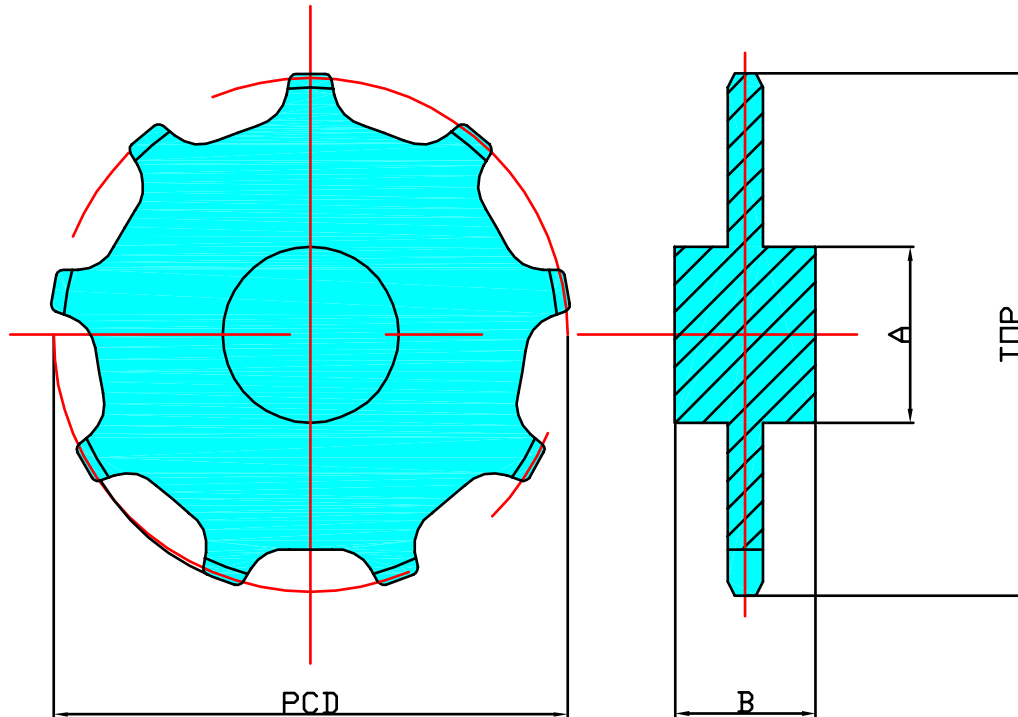

SPROCKET No.	No. OF TEETH	BOSS SIZES				PCD		TOP	
		A		B		in	mm	in	mm
		in	mm	in	mm				
36/PM1700/8T	8	1.97	50	1.57	40	5.14	130.60	5.24	133.00
36/PM1700/10T	10	2.36	60	1.97	50	6.37	161.80	6.54	166.00
36/PM1700/12T	12	2.36	60	1.97	50	7.60	193.00	7.72	196.00



## ACETAL CASE CHAINS

## PM508 DRIVE SPROCKETS

SPROCKET No.	No. OF TEETH	HUB DIAMETER		BOTTOM DIAMETER		PCD		TOP	
		in	mm	in	mm	in	mm	in	mm
36/PM508/8T	8	2.56	65.0	3.95	100.3	5.23	132.8	5.28	134.00
36/PM508/10T	10	2.56	65.0	5.20	132.0	6.47	164.4	6.61	168.00
36/PM508/12T	12	2.56	65.0	6.46	164.0	7.73	196.3	8.03	204.00
36/PM508/15T	15	2.56	65.0	8.35	212.1	9.62	244.3	9.84	250.00



(UK) John King Chains Limited.  
 New Climax Works, Lancaster Way, Sherburn in Elmet LS25 6NS UK  
 Telephone: (44) 01977 681910 Facsimile: (44) 01977 681899  
 E-mail: [admin@johnking-chain.com](mailto:admin@johnking-chain.com)  
[technical@johnking-chain.com](mailto:technical@johnking-chain.com)  
[sales@johnking-chain.com](mailto:sales@johnking-chain.com)

John King (USA) Inc.  
 200 Catherine Street, Unit 7B, E. Peoria IL61611 USA  
 Telephone: 309-698-9250 Facsimile: 309-698-9259  
 E-mail: [salesusa@johnking-chain.com](mailto:salesusa@johnking-chain.com)

Web: [www.johnkingchains.com](http://www.johnkingchains.com)